

Product Catalog 2025



In this catalog:

FOUR BONUS



Customer Profiles

Billy Gropp Page 2

Mark Hathaway Page 12

Anthony Dalle Page 32

Skyler Akason Page 44



Table of Contents

Message from Bob Walker	1	Add-ons: Attachments	
Walker Talk Customer Profile: Billy Gropp	2	Hard Cab	52
Walker Advantages		Soft Cab	52
Front-Mount Deck.....	6	ROPS	53
Short Deck Coupling.....	6	Single-Stage Snowblower 36"	53
Interchangeable Decks and Add-ons.....	7	Spyker® Spreader Attachment	53
Tilt-Open Bodies and Tilt-Up Decks.....	7	Dethatcher	54
Grass Handling System® (GHS).....	8	Boom Sprayer	55
Integrated Components	8	48" Dozer Blade	55
Precision Steering and Handling.....	9	48" Model R Dozer Blade	55
Compact.....	9	Add-ons: Options	
Transmission Oil Performance System (TOPS)™	10	Comfort Seat	56
Kohler PRO 300-Hour Extended Life Oil and Filter.....	11	Suspension Seat.....	56
Walker Talk Customer Profile: Mark Hathaway	12	Armrests.....	56
Models		Utility Bed	57
Model S	16	Headlights	57
Model C	18	Cup Holder.....	57
Model T.....	22	Instrument Panel Cover.....	57
Model D	24	Power Dump.....	58
Model R.....	26	Hi-Dump®.....	58
Model B.....	28	No-Catch Deflector	59
Model H	30	GHS Blower Lockout.....	59
Walker Talk Customer Profile: Anthony Dalle	32	Dump Bag	59
Decks		Dump Bins.....	60
Mulching Decks and Kits	36	Large Hole Screen	60
Collection Decks.....	37	Curb Jumper.....	60
Side Discharge Decks.....	38	Power Tilt-Up®	61
Rear Discharge Decks	39	Breakaway Blades	61
Multi-Deck	40	Dense-Pak Blades.....	61
Deck Add-ons.....	41	Hand Lever Deck Height Adjuster.....	62
Deck Compatibility.....	43	Foot Pedal Deck Height Adjuster.....	62
Walker Talk Customer Profile: Skyler Akason	44	Deck Height Washers.....	63
Add-ons: Implements		Deck Cuff	64
Implement Hitch.....	48	Spread Axle Tail Wheel.....	64
Option: Tail Weights	48	Dual Tail Wheel.....	64
Rotary Broom	49	Single Wide Tail Wheel.....	65
Dozer Blade (48" or 60").....	50	Adjustable Footrests	65
Loader Bucket	50	Tail Wheel Lock	66
Debris Blower	51	Big Tire Kit.....	66
Two-Stage Snowblower (42" or 50")	51	Turf Tires.....	67
		All-Terrain (AT) Tires	68
		Deck Tires.....	69
		Tire Chains	69
		Add-on Compatibility	70
		Walker Mower Specifications.....	Back Cover

Go to walker.com to see more information on all Walker products

Note: Some models in this catalog are shown with non-standard add-ons and options.



Since my dad, brother, and I designed the first Walker Mower in 1977, it has always been intentionally different from other lawn mowers. At the time, my family was frustrated with the challenges we were having with mowing our own lawns quickly, easily, and with satisfying results. There was simply no riding mower available that could mow the way we wanted, so we designed and built our own. Like my dad always said, "If you can't buy it, build it," and so we did.

Over the years we have continued to improve the design of the Walker Mower, with each change improving the Walker's agility, ease of use, and cut quality. Our family has set a high standard of performance, and every aspect of the Walker Mower is created with that standard in mind.

Today, Walker Mowers are American made and hand built with pride in Fort Collins, Colorado. When you buy a Walker, you are not only buying a high-quality product, you are joining the Walker Mower family.

Bob Walker

Bob Walker, Chairman
Walker Manufacturing



A Groundsman Among Boys

Billy Gropp will never forget the time he was servicing a residential property early in his career in the 1980s. The lady of the house would refer to him as “the yard boy.” Billy took it in stride. He just said “Yes, ma’am,” got paid, and moved onto the next property. As a young person trying to build a business, that was the bottom line.

But it still got under Billy’s skin. His vision was to establish a complete groundskeeping company based on tenets like integrity, quality, and professionalism. He decided to simply use that flippant “yard boy” comment as motivation.

Within a few years, Billy’s vision was becoming reality. His company, The Groundsman, was taking on more properties, offering more services, and was becoming a known brand around the Augusta, Georgia, market. Today the company has roughly 40 employees that provide a long list of groundskeeping services to prestigious clients in the health care, commercial and industrial industries. A small portfolio of residential accounts is also maintained, but the focus is definitely commercial.

“It’s much more profitable to work for someone who is spending somebody else’s money,” Billy says. “When a property looks good, a property manager gets a pat on the back from their boss. Now that property manager wants to keep everything going like it has been. So as the contractor, you have to charge enough to provide that level of service. But you never overcharge, ever. You have to build a relationship based on mutual respect and working together.”

Climbing the Rungs of the Commercial Ladder

Prior to starting his groundskeeping company, Billy Gropp was working in a chemical plant. It was a good job, but Billy was just a few years out of high school and full of energy. He’d recently purchased a large riding mower to use on his mother’s property. Billy started to wonder if he could use that machine to mow a few other yards in his spare time.

“That’s when I saw an ad in the newspaper for a groundsman at an apartment complex,” Billy recalls. “I decided to look into it. Turns out, they actually wanted someone who would work directly for them full-time. But I still had my job at the chemical plant. They told me to talk to the manager of another apartment complex on the other side of the interstate. That complex was using a contractor, but they weren’t happy with the quality.”





Billy drove right over there. Lo and behold, the contractor was on-site that day. Billy parked his truck and watched for a while. Then he walked up to the contractor to make a little small talk. "I asked, 'How much do you charge for doing work like this?' He came right out and told me," Billy tells.

Later on, Billy got ahold of that apartment manager and said what he would charge to take care of the mowing and groundskeeping. Billy's price was a little higher than the current contractor's. "But I told the manager that the price was non-negotiable if they wanted their property to look better than it did now," Billy says. Billy got the job and was officially in the groundskeeping business. Inspired by that initial newspaper ad, he decided to call his company The Groundsman. The year was 1979.

Within a couple of years, Billy left his shift work job at the chemical plant. He also started shifting away from the apartment complex market. The Groundsman started taking care of other types of commercial properties including banks, smaller office buildings and restaurants. Before long, the fast food industry became The Groundsman's fast track to the top.

"These places saw the value in nice landscaping. They hired us to do all the new construction and maintenance. McDonald's actually photographed one of the properties and put it on the cover of their franchise magazine, saying this is what every property should look like."

"We picked up some McDonald's locations which were corporate-owned at the time," Billy says. "These places saw the value in nice landscaping. They hired us to do all the new construction and maintenance. McDonald's actually photographed one of the properties and put it on the cover of their

franchise magazine, saying this is what every property should look like."

The Groundsman was taking care of several other fast food restaurants as well, and actually helped pioneer the concept of using annual color on these types of properties. The restaurant market prompted Billy to start changing his views on mowing, too. Rough-cutting wasn't going to cut it any longer. Billy needed to start collecting clippings to make these lawns look pristine. A small walk-behind wasn't a viable option, however, because it wouldn't be productive enough.

Engineering a Way to Increase Productivity

Billy engineered his own homemade ride-on collection mower in the early 1980s. He started with a lawn tractor and a 50-inch mid-mount deck. He built an adapter that attached to the discharge opening. A flex hose connected to that adapter. The flex hose led to a blower assembly with a 5-hp Briggs motor. That led to a tall, rectangular trash can Billy got from one of his fast food clients. Billy also built a frame off the rear axle of the mower where the trash can could

slide in and out. The bag from a Snapper push mower went on top of the trash can to contain the debris.

All things considered, Billy's creation did a pretty good job. But little did he know that a manufacturer in Colorado had recently begun making a ride-on collection mower of its own. Then



Billy Gropp (standing) and Mike Dohn, Billy's vice president of operations who will be taking over the company when Billy decides to retire.

he saw another ad in the newspaper, this time for something called the Walker Mower that an area dealer had begun selling. Billy inquired, and has been using Walker Mowers ever since. Today, The Groundsman has around 15 units in production: all Model T's with 48-inch collection decks.

Making those fast food lawns look pristine is what helped catapult The Groundsman to the top of the commercial market. "Those properties gave us a lot of visibility," Billy says. The Groundsman eventually started shifting from restaurants to larger-scale sites like factories, office complexes and health care facilities.

Four large hospital accounts are managed today, each of which includes a network of satellite offices around the area. "For some reason, the medical industry has been really good to us," Billy says. "They want the quality level up, and also the attention to detail. That's what we pride ourselves on."

Perfecting the Art of Client Retention

The Groundsman started servicing its first hospital in 1989, an account it

still has today. As a matter of fact, the company hasn't lost a commercial account of any kind in more than 12 years.

A big part of The Groundsman's value proposition is the breadth of services it provides. The company does more than mow grass. They trim trees and service irrigation systems. They provide other exterior maintenance services like litter cleanup and pressure washing. Specialized crews blow out parking decks and sterilize ambulance bays at hospitals. Some even clean spider webs from elevator shafts.

The Groundsman has also established a reputation for its willingness to always be on call. That reputation earned the company an opportunity to perform parking lot maintenance at a prestigious sporting event held in the area each spring. The Groundsman has retained that account for a dozen years now, too.

Even though The Groundsman delivers a lot more services than mowing, the appearance of the lawn is still at the top of Billy's list.

"The type of properties we've serviced over the years has changed, but Walkers are still used on what we call our fine lawns," Billy says. "We employ some rough-cut mowers on



The Groundsman landed its first hospital account in 1989, and currently services four hospital accounts.

some of the perimeters of our larger properties. But there is nothing like a Walker for doing detailed mowing on areas that are irrigated and need to look first class."

To profitably deliver such a high level of service, The Groundsman must also function at a high level of efficiency.

"We've found that you make a lot of 'little dollars' in the landscape industry," Billy says. "You have to watch every penny, which translates to every minute. That's where I see a lot of additional benefit from using Walker Mowers. You can trim on each side of the mower and collect the clippings. Then it's easy to turn it around, empty the hopper and go right back to work. Time is money, and everything has to be done as efficiently as possible. We track every

minute of every employee on every job. The Walker has been perfect for that type of work environment."

At age 65, Billy Gropp expected to be backing away from the business more by now. But COVID has disrupted his labor force, which has required Billy to get more involved in certain aspects of the company again. While no specific timetable has been established, there is an exit plan. Mike Dohn is a longtime employee who is poised to become majority owner when Billy does retire. Mike has already been given a small share of the company.

"I decided to make Mike part owner now to give our clients some certainty for the future," Billy explains. "Customer retention is always number one. We've never wanted to be the largest company. We just wanted to provide the best service. That is what has worked for us, and is what will continue working after I step away."

Pretty profound wisdom from a little ole yard boy. Or should I say, Groundsman?

See Billy's story by watching this video.



SCAN ME



While The Groundsman specializes in commercial groundskeeping, a small portfolio of residential properties is maintained.

Walker Advantages

Front-Mount Deck

Flexible deck suspension allows the deck to move independently from the tractor body over hills and valleys



True floating deck freely articulates over uneven terrain

Short Deck Coupling

Scalp less grass on a crest



Cut more grass in a valley



Front-Mount Deck

Achieving a beautiful cut has been our focus from the very first Walker Mower design. Positioning the mowing deck in front of the machine is fundamental to producing high-quality results. The front-mount deck of the Walker reduces impact on the turf prior to cutting, resulting in a more consistent, carpet-like finish. This result is achieved by transferring weight from the deck caster tires which minimizes matting of the grass.

The Walker's flexible deck suspension provides smooth, consistent cutting as the front mounted deck articulates independently of the tractor following ground contour, minimizing scalping, and providing a beautiful cut.

The Walker torsion-flex carrier frame allows the deck to freely articulate and flex laterally, producing a smooth cut, even over complicated ground contours. This makes Walker Mowers ideal for mowing uneven turf.

Short Deck Coupling

Front-mount decks also create a shorter distance between the contact point of the drive tire and the contact point of the front caster tire, allowing Walker decks to precisely follow ground contours. Compared to mid-mount hanging decks used on other mowers, Walker mowing decks scalp less on a crest and leave less uncut grass in the valleys of ground contours.

Interchangeable Decks and Add-ons



Switch the deck for one of a different size or type, or switch to an add-on

Tilt-Open Bodies and Tilt-Up Decks

Easy access to engine and drivetrain



Easy and safe access for deck cleaning and blade maintenance



Interchangeable Decks and Add-ons

Whether handling grass, leaves, debris, or snow, Walker Mowers are designed for year-round productivity. On most models, decks can easily be switched for larger or smaller collection, mulching, or discharge decks to suit the task at hand. Plus, with dozens of add-ons such as a dethatcher, dozer blades, snowblowers, or rotary brooms, the Walker is one of the most versatile mowers on the market.

Tilt-Open Bodies and Tilt-Up Decks

Each Walker features a tilt-open body, quickly exposing the drive belts, electrical system, engine, and drivetrain, making service and maintenance easy. No special tools or equipment are needed. Simply release the body latch and the gas-spring assisted enclosure opens up for unobstructed access to all of the Walker's working components.

All Walker decks quickly tilt up, making maintenance tasks safer and easier.

It takes seconds to unlock, lift, and secure the deck in an up position, providing access to the blades, housing, and chute. H models also have an optional Power Tilt-Up® deck lift. Walker tilt-up decks also allow the Walker Mower to have a smaller footprint when traveling or being stored.

Walker Advantages

Grass Handling System® (GHS) and Integrated Components

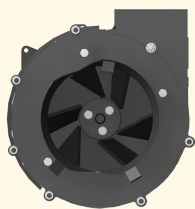

Internal GHS 10.5" (26.67 cm) Blower (Models C19, C19i, T, D)

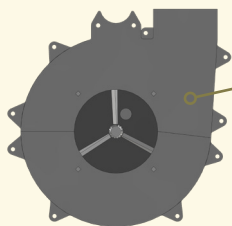

Internal GHS 12.75" (32.38 cm) Blower (Model S)

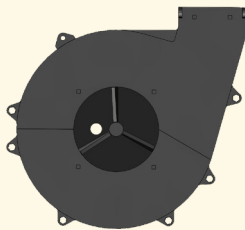

Internal GHS 13.25" (33.66 cm) Blower (Model C23i)

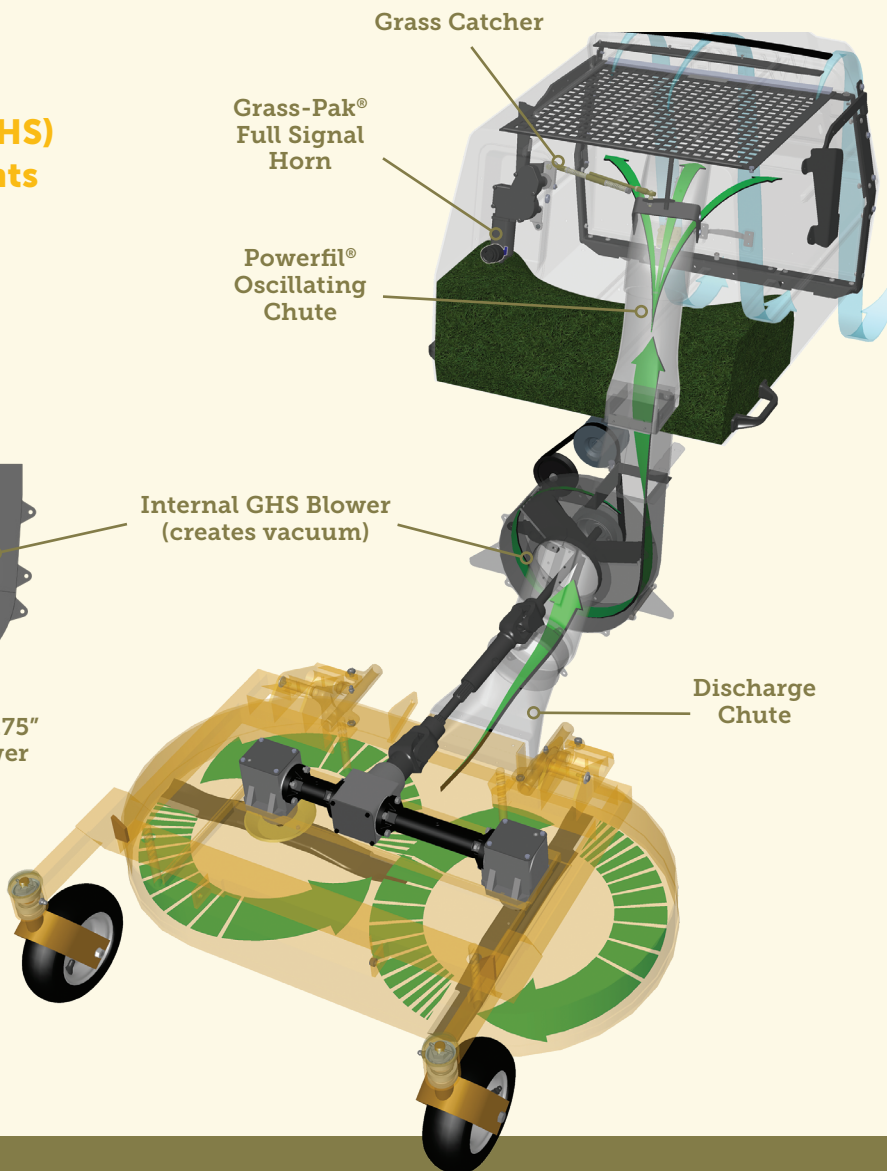

Grass Handling System® (GHS)

Walker invented the internal Grass Handling System® on its first mower, and it remains the most efficient way to vacuum grass clippings, leaves, and debris from the lawn leaving a beautiful, carpet-like finish.

Collection decks move clippings to a center, rear discharge chute where an internal blower vacuums grass clippings and debris, and then blows it directly into a compact,

rear-mounted grass catcher box. The PowerFil® oscillating chute evenly packs clippings, and the Grass-Pak® full signal alerts the operator when it is time to empty the catcher. To dump clippings, the operator can simply tilt the catcher box back with the side handles, or utilize the optional Power Dump or Hi-Dump® add-ons from the operator seat.

Integrated Components

Walker Mowers are engineered to ensure the entire grass collection

system is internal. This intentional effort has allowed Walker Mowers to retain their compact footprint. There are no bulky tubes or bags extending beyond the footprint of the mower.





Compact



Compact

Most lawns have areas with narrow gates, tight spaces between landscape features, or other obstacles that can make mowing difficult. The compact size of the Walker Mower gives you the ability to overcome these challenges more easily and efficiently.

The Walker Mower has a small footprint designed to get into and out of tight places like narrow gates, between beds and trees, fence corners, and other similar landscape features.

Precision Steering and Handling



Precision Steering and Handling

With an operator-friendly combination of fingertip steering and the Forward Speed Control, the Walker Mower goes precisely where you want it to with little effort.

Forward Speed Control

Once in the drive position, the Forward Speed Control uses a friction lock to work as a cruise control, allowing you to control the mower by simply applying pulling pressure on the steering levers. To stop, pull the Forward Speed Control

back to the Neutral-Park position.

Steering Levers

Walker Mower steering levers take control the moment pressure is applied. Each steering lever is spring-dampened, providing smooth machine operation. You can easily steer the machine by controlling both levers with a single hand, only using gentle fingertip pressure. The steering system is designed for precision steering and handling, using optimal linkage geometry and high-quality components.

Walker Advantages

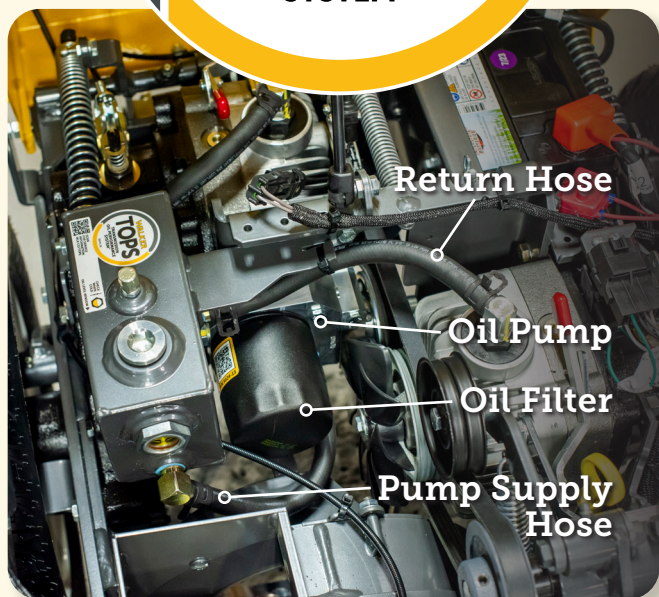

For longer transmission life and extended transmission warranty

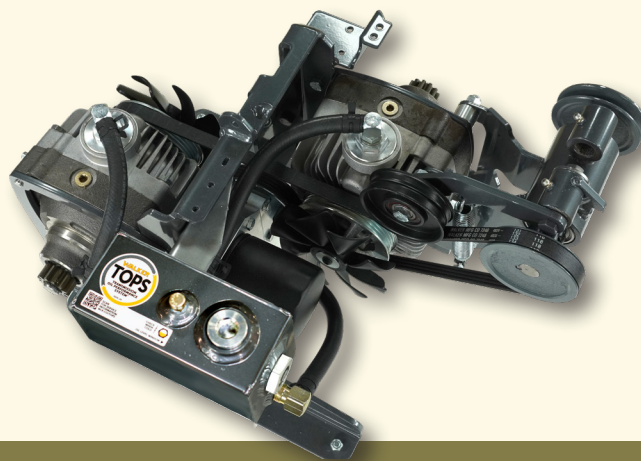

Transmission Oil Performance System (TOPS)™

TOPS™ brings enhanced drivetrain protection and performance to all Walker Mowers equipped with Walker Model 7 hydrostatic transmissions by actively circulating and filtering the transmission system fluid every 38 seconds.

TOPS™ includes:

- A fully-machined, billet aluminum oil pump with integrated filter mount, driven by transmission

drive belt, that circulates filtered oil when engine is running.

- An oil filter with premium fiberglass media made in the USA for Walker.
- Remote steel oil reservoir which doubles oil capacity and reduces oil temperature.
- Fully-synthetic oil formulated specifically for extended transmission life under high loads and in extreme ambient temperatures. Walker Model 7 Hydro Oil P/N 6450-21.

- A maintenance schedule that adds 500-hour oil and filter change interval after the initial 100-hour break-in service.
- Extended transmission warranty when serviced as directed; conditions apply.

See more details at:
walker.com/tops

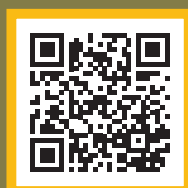

Kohler PRO 300-Hour Extended-Life Engine Oil and Filter

Kohler PRO Synthetic 10W-50 vs Conventional Auto Engine Oil (API-SN)

	Kohler PRO Synthetic 10W-50	Conv. Auto Oil (API-SN)
Guaranteed 300-hour oil change interval	✓	✗
Extra corrosion protection for seasonal storage	✓	✗
Multi-season operation	✓	✗
Superior performance for extreme cold and hot operation temperatures	✓	✗
Lower oil consumption	✓	✗



Standard oil and filter in Kohler engines from Walker provide a three times longer oil change interval.

Kohler PRO 300-Hour Extended-Life Engine Oil and Filter

Kohler PRO 300-hour, extended-life synthetic oil and filter provide unmatched protection for Walker Mowers equipped with Kohler engines. This 10W-50 fully synthetic oil has a 3x longer life, extending oil changes while providing ideal engine protection in all seasons and all temperatures.

- 3X longer oil change interval

- Engineered by AMSOIL exclusively for Kohler
- Fully-synthetic oil formulated specifically for extended oil change intervals in Kohler air-cooled engines
- Guaranteed 300-hour oil change interval on most Kohler gas engines past, present, and future
- 10W-50 viscosity for all-season performance
- Extra corrosion inhibitor for seasonal storage and multi-season use
- Lower oil consumption than conventional oil
- Warranty approved for Kohler engines

See more details at:
walker.com/kohler-engine-oil

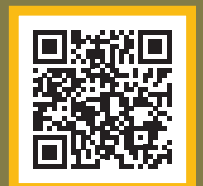



Tristan Smith, part of the team at Beast Mowed Lawn Care, mows in picturesque Deer Lodge, Montana.



Feeding the Beast in the Montana Foothills

Mark Hathaway had spent the better part of 12 years watching from the sidelines. The lawn mowing company he'd started in 2006, in which he still had a small ownership stake, was floundering. Mark could no longer just watch. He decided to leave his full-time job in IT to fully immerse himself in the company. Just a few years later, Beast Mowed Lawn Care in Deer Lodge, Montana, had grown 500%.

"I'd always felt like the company was on the edge of being able to do something great," Mark says. "My boss at my full-time job wasn't happy with me spending so much time on my side gig. I decided it was time to give this lawn mowing thing a legitimate try. Like a bad penny, this business found a way of making its way back to me."

Mark took over the company in the middle of 2020. By the end of 2023, that "bad penny" was generating more than \$500,000 in annual revenue. In addition to mowing and maintenance, Beast Mowed provides fertilization and weed control, light tree trimming, and snow removal. The company has expanded into landscape installations in 2024. Mark gets his hands dirty with all of it, which doesn't bother him at all.

"There's something surreal about an early Montana morning when you're out plowing snow," Mark relates. "It's like no one else exists. Those three or four inches of snow suck up all the ambient noise, and all you can hear is the scrape of the snowplow. Honestly, it's that same kind of feeling that has drawn me to lawns. When you get done with a lawn that looks perfect, when the sidewalk edges

are crisp and the stripes are just bangin', there's a sense of satisfaction you can't get from a lot of jobs. Honestly, I don't even feel like I have a job anymore."

Monster of an Opportunity

Mark Hathaway moved to Deere Lodge, Montana, from Utah in 2004 to run the IT operation at a saw mill. Realizing that homeownership would increase the odds of Mark sticking around, Mark's boss wanted to help Mark find a house. They found a nice place, but it was attached to an adjacent parcel with a huge lawn. Mark's boss decided to buy the property, had it divided, and sold Mark the smaller portion with the house.

"It worked out great for me, but now my boss had this big lawn he needed to have mowed," Mark recalls. "I had done some mowing in college and always enjoyed it. I saw the job the contractor was doing on my boss's lawn and thought I could do better. I suggested that I get a used commercial zero-turn and start mowing it myself. So that's what we did. Before long, other neighbors started asking me

to mow their lawns. Next thing you know, I'm mowing quite a bit. It was almost starting to get in the way of my IT job at the saw mill."

Mark ended up leaving that job to work for the company that made the saw mill's software. That job required a lot of travel, though, which Mark quickly grew tired of. His mowing

kids who worked for me, and would have been crushed if he lost his job because I closed my business," Mark says. "So I basically sold my lawn company, which was called Lawn Monster at that time, to this kid's dad for what the equipment was worth."

It was just a matter of time before Lawn Monster became too monstrous

"When you get done with a lawn that looks perfect, when the sidewalk edges are crisp and the stripes are just bangin', there's a sense of satisfaction you can't get from a lot of jobs. Honestly, I don't even feel like I have a job anymore."

business was still going strong, so Mark continued to make a living by mowing and doing IT consulting.

With his IT consulting gig going well, Mark thought it might be time to get out of the mowing business. He had a problem, though.

"I was really impressed with one of the

for its new owner, too. Mark had another idea. A brother-in-law in Utah, Chaz Frandsen, was struggling to sell insurance after losing his job. "I told him he could make way more money mowing lawns," Mark says. "I suggested he move up to Montana to take over Lawn Monster. He finally agreed in 2018."

Lawn Monster's biggest contract at the time, a church, was looking to consolidate service vendors. That meant Lawn Monster would be asked, if not required, to do the mowing at all of their churches in the area. Furthermore, Lawn Monster would have to provide all of the fertilizing and weed control, tree trimming and planting.

"My brother-in-law realized he was in a little over his head now, especially with the chemical spraying part," Mark says. "I figured I could help him with that. So I did a little research and ended up buying a stand-on spreader-sprayer on my own. I got my chemical applicator's license and took care of those church properties for my brother-in-law."

The rest of the business still got to



Beast Mowed Lawn Care employs primarily high school students. Pictured here in the top row are, from left, Gideon Rubink, Chace Henze, and Mark's son, Zach Hathaway. In front are Mark Hathaway (left) and Tristan Smith.

be too much for Chaz, however, and he wanted to call it quits. Another one of Mark's brothers-in-law, Doug Bull, had also recently moved up to Montana. He ended up buying Lawn Monster from Chaz.

Things were going pretty well for Doug, but not good enough to encourage him to quit his full-time job. "I could see that, at some point, the business was going to fail," says Mark, who at this point was working full-time in IT again. "As busy as I was, I inserted myself into Lawn Monster even more to help Doug manage things. I also started helping with some of the mowing. We needed more help, and were able to convince Tristan Smith to come back, who had worked a short time for Chaz back in 2018."

Tristan has been Mark's right-hand man since Mark took over the company in 2020. By the time he took over, Mark had already put a lot of money into the business to buy more reliable equipment, including a new Walker Model T. "To justify the investment, I figured that if things didn't work out with Doug and Lawn Monster, I'd just keep the new Walker for myself," Mark says.

Things didn't work out with Doug, but they've been working quite well since Mark took over the company. Mark and Tristan immediately changed the name to Beast Mowed Lawn Care, and have been feeding the beast ever since.

Bad Penny Becomes a Booming Enterprise

Southwest Montana is pretty sparsely populated. Thus, Beast Mowed's two mowing crews have to rack up considerable drive time to service all of their account base. That's why Mark says one of the best investments he's made is in vehicle branding.

"The way you make good money in lawn maintenance is by keeping a tight route," Mark says. "With truck branding,



Beast Mowed Lawn Care likes to hire high school kids to teach them how to work. The boys they have sure do work hard, and do a fantastic job. Pictured here is Chace Henze mowing a residential property.

you're advertising in the areas you're already working. Plus, there is no doubt who did the work when they see our truck driving away. The bottom line is that we want a lawn to look perfect when we're done, and we really don't care what kind of equipment we use to make that happen."

It just so happens that a Walker Mower has been Beast Mowed's best option in certain applications. The Model T with a 48-inch collection deck is Beast Mowed's mower of choice on properties of a half-acre to an acre. Mark and Tristan also deploy a Model T on the higher-visibility areas of larger properties. Then, on the outer areas of those larger properties, crews mow with a 60- or 72-inch stand-on with a side-discharge deck.

"I've always liked analyzing data to make better business decisions," Mark says. "I'm constantly looking for the most efficient way to get in and out of a property without cutting corners, because we want our properties to look perfect. Our Walker Mowers have played a big part in that. They are so fast and agile. Even though a Model T is technically slower from a ground speed standpoint, it can beat any stand-on mower on smaller to medium-size properties."

"The Walker is really nimble," Tristan adds. "We also end up trimming a lot

less because the Walker can really maneuver around and get things done the way we want. And on lawns with rolling hills, we don't scalp things up. The floating deck on the Walker really helps on lawns that aren't completely flat."

Mark and Tristan still spend a lot of time in the field working with the crews, especially when they are a bit short-handed. Their employee base consists almost entirely of high school kids. It's something Mark and Tristan take a lot of pride in.

"My belief is that kids need to learn how to work," says Mark, who grew up on a farm. "If you can teach them that when they're young, and can put a little money in their pockets, they'll leave high school as a bigger asset to the community. Along with producing perfectly manicured lawns, the biggest thing we do is grow people. That's important to us."

Just another way they're feeding the beast in the Montana foothills.

See Mark's story by watching this video.



SCAN ME

Model S

Entry-level collection
mower, ideal for
smaller properties



See more details at:
walker.com/model-s



Model S Standard Features

- Grass Handling System® (GHS)
- 7 bushel (8.7 cu. ft.) grass catcher
- Commercial engine air filtration
- Hydro-Gear ZT3100 transmissions
- 12.75" (32.38 cm) Thru-Shaft® PTO GHS blower
- Oscillating PowerFil® chute with Grass-Pak® full signal
- Precision steering and handling
- Forward Speed Control
- Tilt-up decks and tilt-open body
- Flexible deck-carrier frame



The Model S is the quintessential Walker Mower. Inspired by the original 1977 prototype, the Model S is simple and easy to operate, and very efficient at mowing residential properties. With Walker's Grass Handling System® and an elegant, patented Thru-Shaft PTO Blower® design, the Model S is an excellent, entry-level mower for experiencing Walker's signature beautiful cut and zero-turn productivity.



18 HP Briggs and Stratton Vanguard engine

Commercial rated compact V-Twin engine with pressure oil lubrication

7.4 MPH (11.9 KM/h) ground speed

4 gallon (15.1 liter) fuel tank

7 bushel (8.7 cu. ft.) grass catcher

Deck/Kit options:

Collection 36"-48" (91 cm-122 cm)

Mulching 36"-48" (91 cm-122 cm)

Discharge 36"-56" (91 cm-142 cm)



The Walker Dethatcher is a popular Model S attachment perfect for lifting and collecting lawn thatch and debris in one pass, encouraging healthy lawn growth.

Model S Popular Add-ons

- Power Dump
- LED Headlights
- Adjustable Footrests
- Dethatcher
- 48" (122 cm) Dozer Blade
- 36" (92 cm) Single-Stage Snowblower
- Spyker® Spreader with Mount
- Comfort Seat with optional Armrests

The Walker 36" Snowblower attachment can mount in place of the mowing deck to provide winter productivity.



Model C

Commercial collection
mower that is compact
and capable



See more details at:
walker.com/model-c



Model C Standard Features

- Grass Handling System® (GHS)
- 7 bushel (8.7 cu. ft.) grass catcher
- Kohler PRO 300-Hour Extended-Life Oil and Filter
- High capacity, commercial engine air filtration
- Oscillating PowerFil® chute with Grass-Pak® full signal
- Precision Steering and Handling
- Forward Speed Control
- Tilt-up decks and tilt-open body
- Flexible deck-carrier frame



Since its introduction in 1986, the Model C has been continually refined and improved with the commercial operator in mind, especially those who maintain residential properties. The Model C is compact, and with its ability to use implements, is also a very versatile mower with impressive productivity.



Model C19

19 HP Kohler
Command Pro CH620 engine

4 gallon (15.1 liter) fuel tank

7 bushel (8.7 cu. ft.) or 10.0 bushel
(12.4 cu. ft.) grass catcher options

Model 7 transmissions with ductile
cast iron gearbox final drives

Transmission Oil
Performance System (TOPS)TM

Deck/Kit options:

Collection 36"-48" (91 cm-122 cm)
Mulching 36"-60" (91 cm-152 cm)
Discharge 36"-60" (91 cm-152 cm)



Model C23i

23 HP Kohler
Command Pro ECH730 EFI engine

4.7 gal (17.8 liter) fuel tank

7 bushel (8.7 cu. ft.) or 10.0 bushel (12.4 cu. ft.) grass
catcher options

Dual, Independent Hydro-Gear[®] ZT3100 Integrated
Transaxles

13.25" thru-shaft GHS blower

Deck/Kit options:

Collection 42-52" (107 cm-132 cm), Mulching 42-60" (107
cm-152 cm), Discharge 42-60" (107 cm-152 cm)

Model C Popular Add-ons

- LED Headlights
- Dethatcher
- Operator Soft Cab (C19 only)
- Implement Hitch with electric ram lift
- 42" (107 cm) Two-Stage Snowblower
- Comfort Seat (standard on C23i)
- Power Dump
- 48" (122 cm) Dozer Blade

The Walker 48" Dozer Blade can mount in place of the mowing deck as an attachment or with the use of an Implement Hitch for snow removal or light dirt work.



Model Spotlight **C23i**

The next generation
of fast, easy,
beautiful mowing



See more details at:
[walker.com/
models/c23i](http://walker.com/models/c23i)



The C23i incorporates years of development and testing to deliver an upgraded mowing experience that includes efficiency, reliability and low maintenance. The mower is designed to be fast, quiet, simple, and easy to maintain while still providing the top-notch performance that you expect from a Walker Mower.

Fast



This well-balanced mower with a powerful 13.25" thru-shaft GHS blower, and Hydro-Gear ZT3100 transaxles can mow and collect grass at speeds up to 8 MPH.

Quiet



The new design of the Model C23i features in-line power delivery utilizing a swing-away jackshaft and electric PTO clutch, eliminating the need for a PTO gearbox, making quieter operation.

Easy Maintenance



The simplified body and chassis design of the Model C23i has less belts and pulleys, less bearings, no gearboxes, and a reduced parts count. In addition to an easier tilt-open seat panel, the two-piece GHS blower housing design allows for easier maintenance and repairs.

Affordable



With 25% fewer overall total machine components, and 64% less individual chassis parts compared to the Model T, the Model C23i provides excellent performance at a lower price.

Unique Swing-Away Jackshaft gives unobstructed access to GHS blower and other components

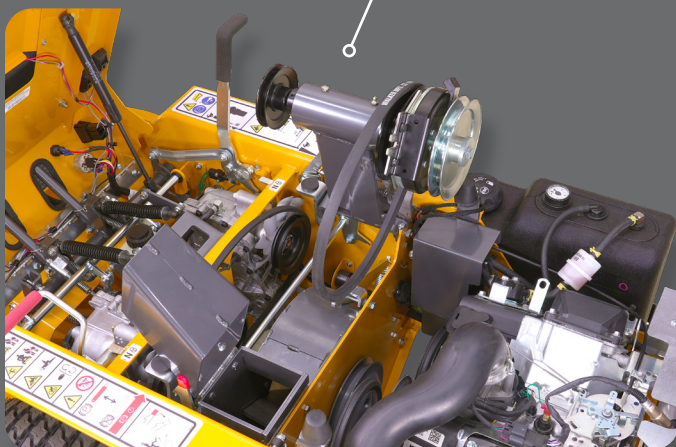

Two Piece Blower Housing provides easier maintenance and removal from above and below

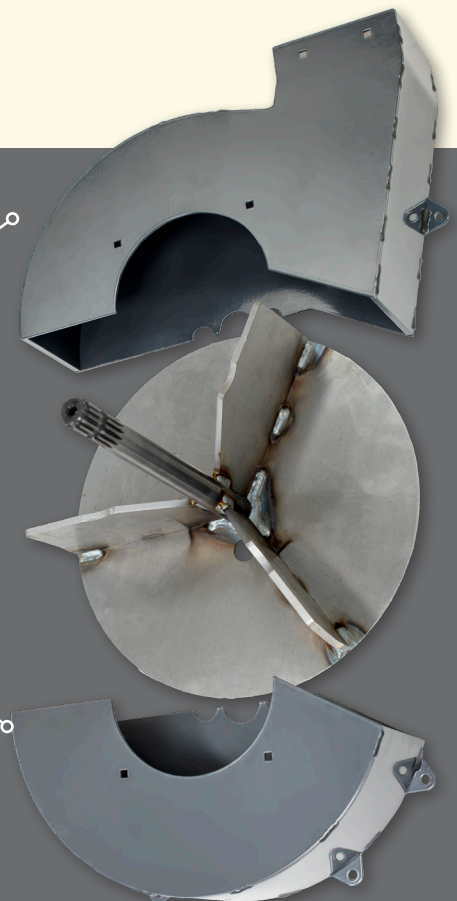

Model **T**

The go-to collection
mower for performance
and versatility



See more details at:
walker.com/model-t



Model T Standard Features

- Grass Handling System® (GHS)
- 10 bushel (12.4 cu. ft.) grass catcher
- Commercial air filter with remote air intake and turbine pre-cleaner
- Model 7 transmissions with ductile cast iron gearbox final drives
- Flexible deck-carrier frame
- Tilt-up deck and tilt-open body
- 4.7 gallon (17.8 liter) fuel tank
- 10.5" (27 cm) GHS blower
- Transmission Oil Performance System (TOPS)[™]
- Kohler PRO 300-Hour Extended-Life Oil and Filter
- Precision steering and handling
- Forward Speed Control



The Model T is the go-to Walker for commercial operations and a favorite among performance oriented customers. Intended specifically for commercial use, each aspect of the Model T has been designed to meet the most demanding expectations of operators who want fast and easy mowing with beautiful results.



Model **T23**

23 HP Kohler Command Pro
CH680 engine

Commercial mower with carbureted engine

Comfort Seat with optional armrests

Non-collection version is available

Deck/Kit options:

Collection 36"-52" (91 cm-132 cm)

Mulching 36"-60" (91 cm-152 cm)

Discharge 36"-74" (91 cm-188 cm)



Model **T27i**

26.5 HP Kohler Command Pro
ECH749 EFI engine

Superior fuel efficiency

Comfort Seat with optional armrests

Non-collection version is available

Deck/Kit options:

Collection 36"-52" (91 cm-132 cm)

Mulching 36"-60" (91 cm-152 cm)

Discharge 36"-74" (91 cm-188 cm)

Model T Popular Add-ons

- Hi-Dump® grass catcher system raises 67" (171 cm) with automatic catcher door actuation
- Power Dump
- LED headlights
- Dethatcher
- Implement Hitch with electric ram lift
- 42" (107 cm) Two-Stage Snowblower
- 48" (122 cm) Dozer Blade
- Spyker® Spreader with Mount

Dump grass without leaving your seat with the Walker Power Dump option.



Model **D**

**Diesel-powered,
versatile, commercial
collection mower**



See more details at:
walker.com/model-d



Model D Standard Features

- Grass Handling System® (GHS)
- Automatic glow plug preheat
- Transverse engine mount
- Liquid-cooled with self-cleaning radiator
- Impressive 34 ft-lb torque
- High-capacity, commercial air filter with remote air intake and turbine pre-cleaner
- Model 7 transmissions with ductile cast iron gearbox final drives
- Grammer four-way adjustable Suspension Seat
- Tilt-up deck and tilt-open body
- Flexible deck-carrier frame
- High output 40-amp charging system
- 10.5" (27 cm) GHS blower
- Oscillating PowerFil® chute with Grass-Pak® full signal
- Transmission Oil Performance System (TOPS)™
- Precision steering and handling
- Forward Speed Control

The Model D is an industrial-grade Walker Mower with impressive power and agility. The Model D is the only diesel-powered Walker Mower equipped with the Walker Grass Handling System® (GHS). The Model D effortlessly handles the harshest mowing environments and extended running times without compromising efficiency or power.



Model *D*21d

20.9 HP three-cylinder Kubota D722 diesel engine

4.7 gal (17.8 liter) fuel tank

10 bushel (12.4 cu. ft.) grass catcher

Transmission Oil
Performance System (TOPS)™

Deck/Kit options:

Collection 36"-52" (91 cm-132 cm)

Mulching 36"-60" (91 cm-152 cm)

Discharge 36"-74" (91 cm-188 cm)



The Walker Hi-Dump® raises 67 inches and dumps collected grass and debris into a truck or trailer with a 20-second cycle time.

Model D Popular Add-ons

- Hi-Dump® grass catcher system raises 67" (171 cm) with automatic catcher door actuation
- Power Dump
- LED Headlights
- Dethatcher
- Operator Soft Cab
- Implement Hitch with electric ram lift
- 42" (107 cm) Two-Stage Snowblower
- 48" (122 cm) Dozer Blade

The Walker Operator Soft Cab and 42" Snowblower increase year-round productivity.



Model *R*

**Lowest priced,
non-collection Walker
mower, designed
specifically for
residential owners**



See more details at:
walker.com/model-r



Model R Standard Features

- 22 HP Kohler KT722 with Smart-Choke® technology for easy starts in hot or cold weather
- Dual Independent Hydro-Gear EZT-2200 Integrated Transaxles
- Ogura® electric blade clutch and brake with easy pull/push switch operation
- Tilt-up deck and tilt-open seat
- 3 gallon (11.4 liter) fuel tank with integrated fuel level gauge
- Flexible deck-carrier frame allows the deck to freely articulate and twist laterally, producing a smooth cut, even over complicated ground contours
- Kohler PRO 300-Hour Extended Life Oil and Filter
- Precision Steering and Handling
- Forward Speed Control



The Model R is the perfect Walker Mower for residential owners. The belt-driven mower blades are smooth and quiet, while the fingertip steering makes operation of the mower precise and easy. The Model R provides a premium Walker experience at an economical price, so you can bring home fast, easy, beautiful mowing.



22 HP Kohler KT722 with Smart-Choke technology

Belt-driven blades with dampened belt-tensioner for smooth, quiet operation

Side discharge deck cutting width configurations: 42" (107 cm), 48" (122 cm), or 54" (137 cm)

Mulch kits available for 42" (107 cm) and 48" (122 cm) side discharge decks

3 gallon (11.4 liter) fuel tank

Molded rubber side discharge deflector shield

Three-year, 300-hour, caster-to-caster residential warranty. All parts and components are covered against manufacturer's defect.



The Accelerator[®] grass catcher can be placed on any Model R side discharge deck and used for collection of yard debris, leaves, and grass clippings.

Model R Popular Add-ons

- 48" (122 cm) Dozer Blade
- Mulching Kit including bolt-in baffles and serrated mulching blades
- Accelerator[®] 3.3 bushel (4.2 cu. ft.) side-mount grass catcher
- Comfort Seat
- Armrests
- Tow Hitch
- LED light kit

The Walker Model R 48" dozer blade, which can mount in place of the mowing deck, is ideal for removing snow from sidewalks and driveways or to function as a light utility tool for moving dirt, mulch, or other debris.



Model *B*

Discharge or mulch, lightweight, responsive, and well balanced for superior use on hills



See more details at:
walker.com/model-b



Model B Standard Features

- Hydro-Gear ZT3100 transmissions
- High-capacity, commercial engine air filtration
- 8 MPH (13 km/h) maximum ground speed
- Tilt-up deck and tilt-open body
- Kohler PRO 300-Hour Extended Life Oil and Filter
- Flexible deck-carrier frame allows the deck to freely articulate and twist laterally, producing a smooth cut, even over complicated ground contours
- Precision steering and handling
- Forward Speed Control



The Model B is compact, balanced, and fast. It is a Walker Mower designed to run side discharge and mulch decks on difficult properties with hills, uneven terrain, and obstacles, all while leaving a beautiful cut. Plus, with a variety of spring and winter add-ons, the Model B is capable of productivity in any season.



22.5 HP Kohler Command Pro
CH680 engine

Commercial mower with carbureted engine

Integrated Ogura® electric clutch with Soft Start

4.7 gallon (17.8 liter) fuel tank

Deck/Kit options:

Mulching 36"-60" (91 cm-152 cm)

Discharge 36"-74" (91 cm-188 cm)



26.5 HP Kohler Command Pro
ECH749 EFI engine

Superior fuel efficiency and economy

Integrated Ogura® electric clutch with Soft Start

4.7 gallon (17.8 liter) fuel tank

Deck/Kit options:

Mulching 36"-60" (91 cm-152 cm)

Discharge 36"-74" (91 cm-188 cm)

Model B Popular Add-ons

- Utility Bed
- 36" (92 cm) Single-Stage Snowblower
- Spyker® Spreader with Mount
- 48" (122 cm) Dozer Blade
- LED Headlights
- Suspension Seat
- Big Tire Kit
- Tow Hitch
- Dethatcher
- Implement Hitch
- Accelerator® 3.3 bushel (4.2 cu. ft.) side-mount grass catcher

The Spyker Spreader attachment is excellent for spreading fertilizer or herbicides.



Some models shown with optional equipment.

Model **H**

**High production,
discharge or mulching,
versatile commercial
mower**



See more details at:
walker.com/model-h



Model H Standard Features

- Hydro-Gear ZT3400 transmissions
- High capacity, commercial engine air filtration
- Grammer 4-way adjustable Suspension Seat
- 9.4 gallon (35.6 liter) fuel capacity, dual tanks
- Flexible deck-carrier frame allows the deck to freely articulate and twist laterally, producing a smooth cut, even over complicated ground contours
- Tilt-up deck and tilt-open body
- Forward Speed Control
- Precision Steering and Handling



The powerful Walker Model H excels at high production mowing, and has an efficient machine design for overall fuel, time, and operating cost savings. Plus, with a variety of available add-ons, the Model H can be productive year-round.



Model **H**24d

23.7 HP Kohler KDW1003 diesel engine

9.4 gal (35.6 liter) fuel capacity,
two independent 4.7 gal (17.8 liter)
tanks with selector valve

Rubber isolation engine mounts

Liquid cooled with
self-cleaning radiator

Dual Independent Hydro-Gear
ZT3400 Integrated Transaxles

Standard ROPS and Utility Bed

Deck/Kit options:

Mulching 48"-61" (122 cm-155 cm)
Discharge 48"-74" (122 cm-188 cm)



Model **H**27i

26.5 HP Kohler Command Pro
ECH749 EFI engine

9.4 gal (35.6 liter) fuel capacity,
two independent 4.7 gal (17.8 liter)
tanks with selector valve

Kohler PRO 300-Hour
Extended Life Oil and Filter

Dual Independent Hydro-Gear
ZT3400 Integrated Transaxles

The lightest weight Model H,
minimizing turf rutting

Deck/Kit options:

Mulching 48"-61" (122 cm-155 cm)
Discharge 48"-74" (122 cm-188 cm)



Model **H**38i

38 HP Kohler Command Pro
ECH980 EFI engine

9.4 gal (35.6 liter) fuel capacity,
two independent 4.7 gal (17.8 liter)
tanks with selector valve

Increased displacement and torque

Cyclonic high-capacity air filter

Dual Independent Hydro-Gear
ZT3400 Integrated Transaxles

The most powerful Model H with a
big block, fuel-injected engine

Deck/Kit options:

Mulching 48"-61" (122 cm-155 cm)
Discharge 48"-74" (122 cm-188 cm)

Model H Popular Add-ons

- Power Tilt-Up® deck lift
- LED Headlights
- Deck arm adapter kit, allowing compatibility with six additional Walker mowing decks
- Operator Hard Cab
- Implement Hitch
- 50" (127 cm) Two-Stage Snowblower

- 60" (152 cm) Rotary Broom
- 60" (152 cm) Dozer Blade

The Walker Operator Hard Cab, Implement Hitch, and 60" Rotary Broom help increase winter productivity.





Brad Rawlings has been employed at Outscapes Horticultural Solutions in Canberra, Australia, for 15 years.

Passion and Quality Work Together Well in Australian Capital

Twenty years ago, Anthony Dalle of Canberra, Australia, started mowing lawns with an old “hand-me-down” push mower and an old van. Dalle says most of his business was built by just knocking on doors during evenings and weekends. “I just went door to door in my spare time asking people if they wanted their lawns mowed or hedge work done, and it just exploded from there.” He says it soon turned out to be a full-time position for one person.

Fast forward through three years of numerous door knocks, vibrant word of mouth, and just plain old hard work, and Anthony found himself in the middle of an increased demand for his services. The main part of that demand came by way of a large multi-unit complex that Anthony contracted with in 2006, and this is when he says he needed to buy his first Walker Mower—a secondhand 16 HP Model D (diesel). Dalle says that mower was instrumental in their success, as it helped define his company as a serious contractor and raised their level of quality. He says they ran their first diesel Walker hard until it “finally expired” which led him to his first new Walker Mower purchase. Since then, they have purchased 22 Walkers and currently run 11 full time on their daily crews with one on hand as a backup.

When listening to the determination in Anthony’s voice as he tells this part of his story, it is no surprise that he has grown his company, Outscapes Horticultural Solutions, to employ 19 people and care for 220 properties in and around Canberra.

Mixed into his pool of 19 employees are horticulturists, horticulture apprentices, and general landscape laborers. Dalle says he sends teams out in numbers of two to five each day and includes a horticulturist on each team. He says the teams each do their own weekly runs to contribute to Outscapes maintaining 220 properties per week.

Dalle says the involvement of their staff horticulturists is critical to the overall success of their program: “All our horticulturalists are trained in-house through an apprenticeship program that we offer.” He adds, “Retaining them can sometimes be challenging, but I find that providing a flexible workplace, quality equipment and vehicles and having a client base with high-end gardens/grounds goes a long way in helping retain staff.” Anthony extends his point to include pride in workmanship: “Having high-end grounds also gives us a huge sense of job satisfaction when the weekly visit to a property is complete and you can stand back and admire your quality workmanship.”

Quality Meets Experience

To really know about Anthony’s green care background and where his passion started for lawn care, you have to rewind the tape to his childhood when he spent time with his grandfather in Melbourne and took a liking to mowing at a young age: “I just always had a vested interest in it. I literally enjoyed doing it when I was a kid, believe it or not,” recalls Dalle. “I used to spend a lot of time with my grandfather at his place in Melbourne



Anthony Dalle (center) is the owner of Outscapes Horticultural Solutions, and works with two of his 19 employees on his own crew; Aaron Mclean (left) and Brad Rawlings (right).

push mowing his lawns and just always had an interest in beautiful, manicured lawns.”

Even though Anthony is a self-described “man of few words,” he does not lack any words when it comes to detailing what it has taken for his company to develop and maintain their reputation. A large part of Outscapes’ identity in the area has to do with the high-quality impression they show up with and results they leave on each property. Besides showing up in clean vehicles with well-presented employees, Dalle says it is the results that they leave that is their greatest calling card. He also says that customers often notice and acknowledge their quality results. He cites when they switched to the Walker 52” deck as a tool that specifically helps them leave beautiful results. He says one client with a 22,500 square meter property immediately noticed when they changed to the 52” reverse rotation collection deck, “The reverse rotation just gives us a fantastic, much cleaner, sharp cut, and the first mowing application we did here, the client picked up on it straight away

how impressive the finish was.” He says even with the size the company has grown to, they have to listen to what his customers say, so they can stay in touch with the quality that is demanded. Knowing the types of cool climate grasses they maintain and how to properly care for them is critical, according to Dalle. He says most of the turf they maintain is a

in autumn,” explains Dalle. “And just the fact that the Walker can clean up debris efficiently and quickly leaves lawns with nice groomed marks and a quality cut.”

As Anthony talks about Walker Mowers, he brings up how reliable they are and how his local dealer, ACT Small Engines of Canberra, has

“...we have a huge amount of leaf fall generation in autumn, and just the fact that the Walker can clean up debris efficiently and quickly leaves lawns with nice groomed marks and a quality cut.”

fescue/rye mix that holds its color well as long as they mow it high and give it plenty of water.

Anthony says that not only do his Walker Mowers deliver in the summer with beautiful results, he also points out the Walker as a multi-season tool that works exceptionally well in autumn for leaf cleanup. “Particularly here in ACT (Australian Capital Territory) we have a huge amount of leaf fall generation

been a great resource for them since the beginning. “They give technical support and are a fantastic dealership,” he says. “The response we get when we pick up the phone and give them a call is always fantastic.”

The knowledge that Outscapes has acquired over the years has paid off, as they continue to attract new customers even when doing no advertising.

Anthony kind of even impresses himself when he lists off the different types of clients they service. "We maintain body corporates, commercial offices, schools, child care centers, and high-end residential," recalls Dalle. "It's our quality of work that gets us our new contracts." Anthony says it's common for customers to see Outscapes' work and contact them directly, looking for the same results.

While listening closely to customer input is critical to the success of Outscapes, Anthony also says that recognizing how customers have changed over the years has also helped guide the company. He says that in over twenty years of business, the expectations that customers have of quality of service has increased and that he and his team have had to commit to give 110% at all times.

Keep Going with Quality

To be sure, his passion for beautiful, manicured lawns has served him well over the years, as he has worked hard to dial into a certain type of customer. Dalle says their ongoing focus for the future will continue to be high-end property owners who desire the kind of work they can bring at the level they have come to be known for over the last twenty years. Anthony says his desire for the future also includes involving his three sons (currently twelve, ten and two) to be the next generation of Outscapes. "My 12-year-

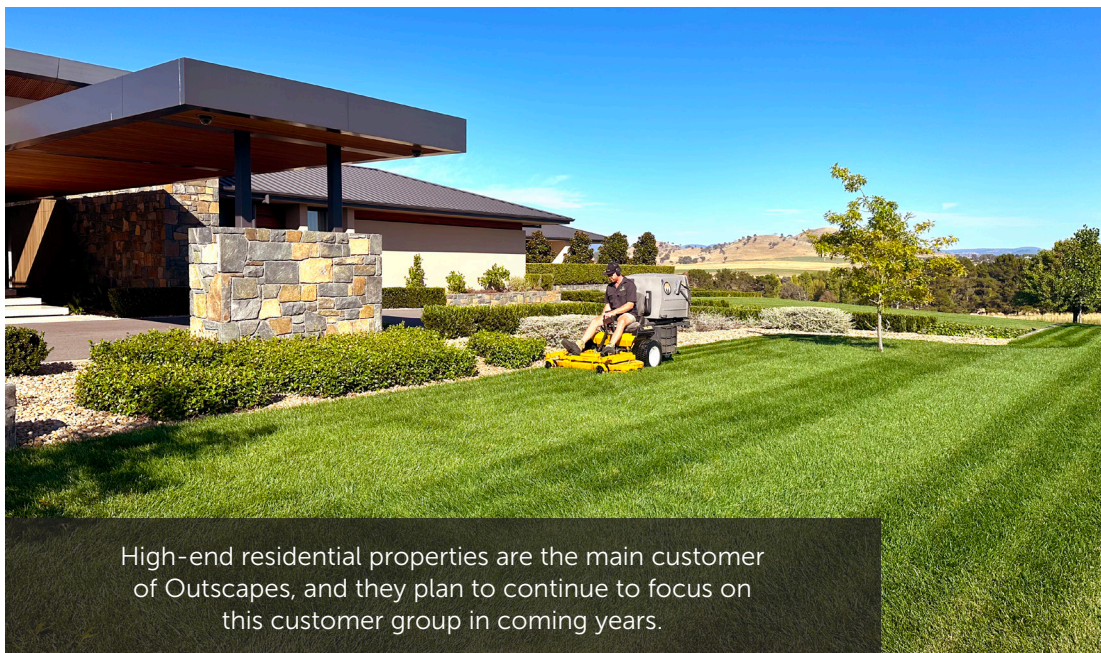

High-end residential properties are the main customer of Outscapes, and they plan to continue to focus on this customer group in coming years.

old, Jackson, loves the mowers, and he loves to come to work with me," he shares with a proud grin. He adds that he has a great group of managers that he is confident in taking over leadership roles.

For their 20th year of business, Anthony says during their offseason he plans to get the staff and families together for a celebration dinner, and he is also updating employee uniforms with an additional logo to recognize the milestone.

A grin comes to Dalle's face as he reflects on his own experience when asked what he would say to landscape contractors who have never used a

Walker: "Do yourself a favor and get a demo. Absolutely amazing quality machine that does an absolutely quality cut day in and day out." He grows more serious as he leans in, "We do between 500-600 hours a year on each of them and they are a real workhorse with minimal downtime and get over the ground real quick, and they give you a quality cut every time."

Anthony says he loves what he is doing and that starting and leading Outscapes for 20 years has been, and still is, enjoyable, and he is still having fun. "I wouldn't have it any other way—I wouldn't be here otherwise, still enjoy it every day . . . love getting out of bed."



The 52" Walker collection deck is a favorite among Outscapes customers for its finished cut.

See Anthony's story by watching this video.



SCAN ME

Walker Decks: Mulching and Collection

Mulching Decks and Mulching Kits



See more details about mulching decks: walker.com/decks#mulching

Mulching Decks and Mulching Kits

Mulching decks and kits are designed to efficiently re-cut material to fine particles and return them to the turf, leaving a beautiful cut.

Each Walker deck is uniquely configured to meet a very specific performance need. Whether the most important consideration in looking for the perfect deck is cutting width, handling grass clippings, material capacity or grass type, there is a Walker deck that will meet the specific maintenance need.

M36

- 36" (91 cm)
- Gear Drive
- Compatible with Models S, C19, C19i, T, D, and B

M42

- 42" (107 cm)
- Gear Drive
- Compatible with Models S, C, T, D, and B

M42B

- 42" (107 cm)
- Gear Drive
- Compatible with Models S, C, T, D, and B

S42-R Mulch Kit

- Mulch Kit for S42-R
- P/N 1692-19

- Compatible with Model R only

M48

- 48" (122 cm)
- Gear Drive
- Compatible with Models S, C, T, D, B, and H*

S48-R Mulch Kit

- Mulch Kit for S48-R
- P/N 1692-20
- Compatible with Model R only

M52

- 52" (132 cm)
- Gear Drive
- Compatible with Models T, D, B and H*

S52 Mulch Kit

- Mulch Kit for S52
- P/N 8691-25
- Compatible with Models C, T, D, B, and H*

S60 Mulch Kit

- Mulch Kit for S60
- P/N 2692-2
- Compatible with Models C, T, D, B, H*

S61 Mulch Kit

- Mulch Kit for S61
- P/N 2692-1
- Compatible with Model H only

*Model H requires a Deck Arm Adapter Kit P/N 2430-10 for this deck.

Collection Decks

Standard Rotation:
Good for thick, wet, or heavy
clippings and debris



Reverse Rotation:
Exceptional cut quality when
clippings are light and dry



See how GHS works
walker.com/grass-handling-system



More about collection decks:
walker.com/decks#collection



Collection Decks

Collection decks are compatible with the Walker Grass Handling System® (GHS) Models S, C, T, and D. Clippings are discharged from the deck through the internal blower and discharge chute and are stored in the GHS catcher box.

Standard vs Reverse Rotation
Standard Rotation Blades come together at the front of the deck, moving material directly into the rear discharge chute. Standard rotation decks

are ideal for users who need to collect thick, heavy clippings, including leaves and other yard debris.

Reverse Rotation Blades

come together at the rear of the deck, moving material around the edges of the deck before it is channeled into the discharge chute. Reverse rotation decks are ideal for users looking for exceptional cut quality in mowing conditions without wet, heavy clippings or debris.

C36R

- 36" (91 cm)
- Reverse Rotation
- Compatible with Models S, C19, C19i, T, and D

C42

- 42" (107 cm)
- Standard Rotation
- Compatible with Models S, C, T, and D

C42R

- 42" (107 cm)
- Reverse Rotation
- Compatible with Models S, C, T, and D

C48

- 48" (122 cm)
- Standard Rotation
- Compatible with Models C, T, and D

C48R

- 48" (122 cm)
- Reverse Rotation
- Compatible with Models S18, C, T, and D

C52R

- 52" (132 cm)
- Reverse Rotation
- Compatible with Models C19i, T, and D

Walker Decks: Side and Rear Discharge



Side Discharge Decks

Sizes range from
36" (91 cm) to 74" (188 cm)



See more:
[walker.com/
decks#discharge](http://walker.com/decks#discharge)

Side Discharge Decks

Side discharge decks cleanly and evenly discharge cut grass from under the deck housing to the right of the operator.

S36

- 36" (91 cm)
- Gear Drive
- Compatible with Models S, C19, C19i, T, D, and B

S42

- 42" (107 cm)
- Gear Drive
- Compatible with Models S, C, T, D, and B

S42-R

- 42" (107 cm)
- Belt Drive
- Compatible with Model R only

S48-R

- 48" (122 cm)
- Belt Drive
- Compatible with Model R only

S48

- 48" (122 cm)
- Gear Drive or Belt Drive
- Compatible with Models S, C, T, D, B, and H*

S52

- 52" (132 cm)
- Belt Drive
- Compatible with Models C, T, D, B, and H*

S54-R

- 54" (137 cm)
- Belt Drive
- Compatible with Model R only

S56

- 56" (142 cm)
- Gear Drive
- Compatible with Models S, C, T, D, B, and H*

S60

- 60" (153 cm)
- Belt Drive
- Compatible with Models C, T, D, B, and H*

S61

- 61" (155 cm)
- Belt Drive
- Compatible with Model H only

S74

- 74" (188 cm)
- Gear Drive
- Compatible with Models T, D, B, and H*

*Model H requires a Deck Arm Adapter Kit P/N 2430-10 for this deck.

Gear vs Belt Drive Decks

Gear Drive:

Smooth, exceptional cut quality

S48 Gear Drive Deck
(top view, cover removed)

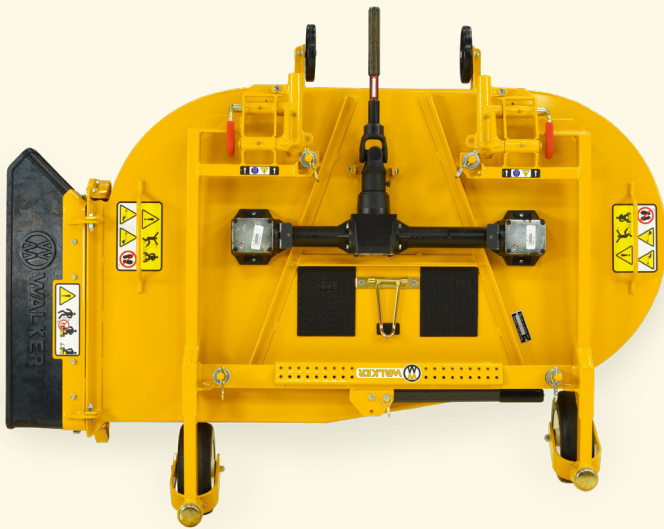

Belt Drive:

Flexible mowing, even in rough conditions

S48 Belt Drive Deck
(top view, cover removed)

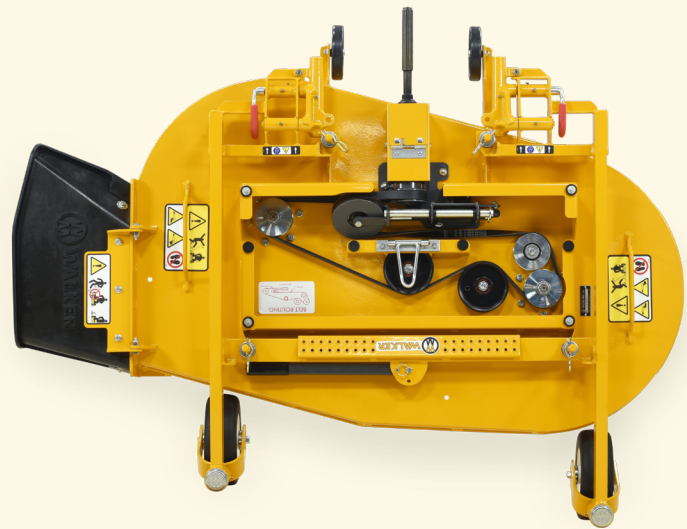

Rear Discharge Decks

Designed specifically for Model H mowers with high production and fast mowing speeds, Walker rear discharge decks process clippings numerous times before cleanly and evenly discharging clippings out the back of the deck, leaving an evenly cut turf.

Gear vs Belt Drive

Walker gear-driven decks utilize aluminum or cast iron gearboxes with Zerol bevel gear technology for durable and quiet function. The timed blades provide

exceptional cut quality and striping, and allow a compact design for improved trimming and maneuverability.

Walker belt-driven decks use a robust spindle and belt-tensioning idler design, and are best suited for rougher mowing conditions with debris or ground contact occurring. Walker belt-driven decks feature tool-free belt change and easy-to-maintain spindles and components.

R52

- 52" (132 cm)
- Belt Drive
- Compatible with Model H only

R64

- 64" (163 cm)
- Belt Drive
- Compatible with Model H only

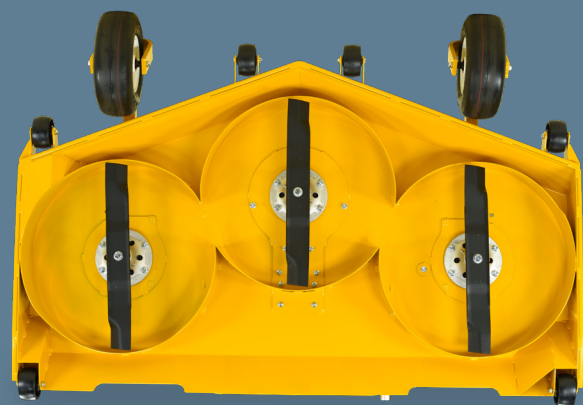

64" Rear Discharge Deck tilted up

Walker Decks: Multi-Deck and Add-ons

Multi-Deck

One deck, multiple uses

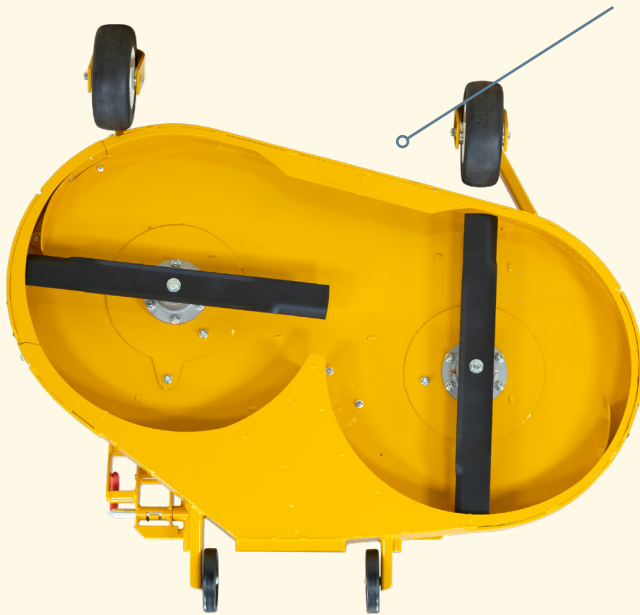

Collection configuration

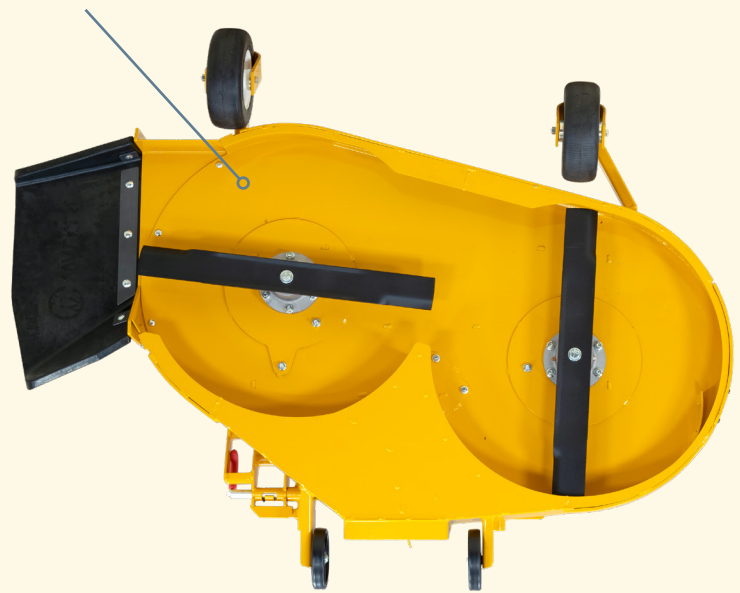

Side Discharge configuration

Multi-Deck

Designed for customers who need to collect and side discharge throughout the season, the Walker Multi-Deck is a cost effective way to have two mowing styles in a single deck. This quiet, belt-driven deck uses a torsion-flex carrier to freely articulate and follow ground contour for a beautiful cut. And, like other Walker decks, the underside and blades are accessible with the tilt-up function for easy transition between configurations and maintenance.

U48

- 48" (122 cm)
- Belt Drive
- Compatible with Models S18, C, T, and D

The Walker Multi-Deck shown on a Model C23i in a collection configuration.



Deck Add-ons

Dethatcher



Spyker® Spreader Attachment



Pneumatic Deck Tire



Deck Cuff

Deck Add-ons¹

Dethatcher Attachment

- Clips on the front of 42", 48", or 52" gear driven decks
- When used with GHS, lawn thatch and debris are removed in one pass
- Gauge wheels and hinged frame allow the dethatcher to closely follow terrain
- P/N A10

Pneumatic Deck Tires

- For use on gear drive decks (36"-56")
- Tire and inner tube only (P/N 5715-15)
- Tire, inner tube, and wheel assembly P/N 5715-24

Deck Height Adjuster

- The mechanical Deck Height Adjuster can install onto some Walker mowing decks.
- It offers cutting height adjustments in 1/4" increments, using a single hand lever within reach of the operator seat.
- C36R, S36, M36: P/N A22
- C42, S42, M42²: P/N A23/A53
- C48, S48, M42B, M48²: P/N A24/ A54
- C48R, C52R²: P/N A25/ A54
- S52²: P/N A26
- S62²: P/N A27
- S56: P/N A28
- C42R: P/N A29

Adjustable Footrests

- These Adjustable Footrests clamp onto the carrier frame.
- They increase comfort for operators with shorter legs.
- 36", 42": P/N 8662-10
- 74": P/N 8662-9

Spyker® Spreader with Mount

- The Spyker® Spreader Attachment combines a Spyker® S80-12010 Pro-Series Spreader with the Walker Mower. No tools are needed to secure the spreader to the carrier frame of the Walker 42", 48", or 52" gear-driven decks.
- P/N A55

Deck Cuff Kit

- The Deck Cuff acts as a channel to direct grass at the edge of the deck into the blade cutting path.
- C36R: P/N 7704-2
- C48R: P/N 7704-4
- C52R: P/N 7704-5

Curb Jumper

- This 36" (91 cm) wide ramp allows Walker Mowers to back over a standard curb.
- The ramp stows on the mowing deck carrier frame.
- Standard decks except 48" and 52", prior to deck S/N 220949*: P/N 5597
- Decks with Deck Height Adjuster (A22-A29 only): P/N 5597-1

¹ Visit walker.com for deck add-on compatibility. ² See dealer for details.

Walker Decks: Deck Add-ons

Deck Add-ons



**Accelerator®
Grass Catcher Kit**

**Boom Sprayer
Attachment**



Power Tilt-Up®

- For the Model H
- Tilt-up action uses a 12-volt electric linear-actuator easily mounted to any Model H mower equipped with an S61, R52, or R64 deck with adjustable footrests.
- The use of a tail weight is suggested when using this option (see page 48).
- H27i, H38i: P/N A35
- H24d: P/N A36

Accelerator®

Grass Catcher Kit

- 3.2 Bushel catcher clips on side discharge opening of S42-R, S48-R, S54-R (Model R21), and the S48-3 deck.

- Includes counter-balancing weight for even mowing as catcher fills.
- Durable, lightweight welded aluminum housing
- Kit P/N A40 (42" deck)
- Kit P/N A41 (48" decks)
- Kit P/N A42 (54" decks)

Boom Sprayer Attachment

- Easily mounts to most 42", 48", and 52" Walker decks*
- Boom delivers a 96" (244 cm) spray pattern and a spray gun with a 20-foot

(6 meter) hose allows the operator to leave the mower and apply liquid material to all landscape features.

- The 25-gallon (95 liter) tank allows easy cleaning of the tank and spray system.
- P/N A57

Breakaway Blades

- Breakaway Blades lessen the impact and shock loading on the deck drivetrain and reduce blade damage.

- S56: **P/N 5705-32**
- S42: **P/N 5705-33**
- S74: **P/N 5705-34**
- S48: **P/N 7705-8**

Dense-Pak Blade Set

- Reduce size of clippings for a more densely loaded catcher when using the Grass Handling System® (GHS); allowing for longer mowing times before needing to dump the catcher. **P/N 7705-60**

Learn more about the passion and philosophy behind the design of Walker decks: walker.com/advantage/beautiful-cut/by-design

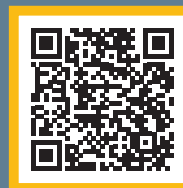

Deck/Kit Compatibility

Decks/Kits	Models						
	S	C	T	D	R	B	H
Collection							
C36R	●	★	●	●			
C42/R	●	●	●	●			
C48		●	●	●			
C48R	●	●	●	●			
C52R		⬢	●	●			
Discharge							
S36	●	★	●	●		●	
S42	●	●	●	●		●	
S42-R					●		
S48-R					●		
S48	●	●	●	●		●	▲
S52		●	●	●		●	▲
R52							●
S54-R					●		
S56	●	●	●	●		●	▲
S60		●	●	●		●	▲
S61							●
R64							●
S74		X	●	●		●	▲
Mulching							
M36	●	★	●	●		●	
M42	●	●	●	●		●	
M42B	●	●	●	●		●	
S42-R Kit					●		
S48-R Kit					●		
M48	●	●	●	●		●	▲
M52		X	●	●		●	▲
S52 Kit		●	●	●		●	▲
S60 Kit		●	●	●		●	▲
S61 Kit							●
Multi-Deck							
U48	●	●	●	●			

● Compatible. ⬢ Model C19i and C23i only. ▲ Requires Deck Arm Adapter Kit P/N 2430-10. ★ C19 and C19i only. X C23i only.

Collection



Discharge



Mulching



Multi-Deck

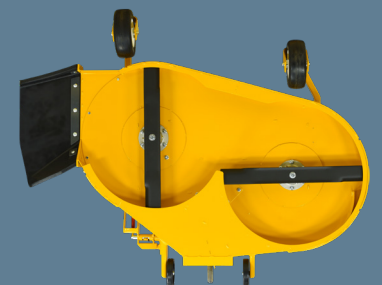



Full-Service Firm is Fussy in Fargo

Precision Lawn & Landscape's motto is "always in our element," which speaks to the company's ability to deliver a range of landscape design/build, lawn care and snow removal services. But it's the element of consistency that has allowed the Precision team to continue living up to the company name.

"When I started the company, I did all of the work myself and was very meticulous about everything," says Skyler Akason, founder and president of Precision Lawn & Landscape in Fargo, North Dakota. "As we've grown and

I've had to rely more on other people, I've been very fortunate to have a great group of employees who care as much about the company as I do."

It's difficult to teach employees to care, but company leaders can inspire them with their own attitudes and actions. The training component is also crucial. Precision Lawn & Landscape's Chief Operations Officer, Brady, oversees the hiring and training processes. He relies heavily on his division managers and foremen to ensure that skills are developed and standards are maintained.

"Luckily, we've seen the post-COVID labor market flow in the right direction," says Brady, a veteran of the U.S. Air Force who joined Precision Lawn & Landscape in June 2023, after transitioning back to civilian life. "We're seeing more applicants nowadays, and we're seeing higher-quality candidates."

Precision Lawn & Landscape has some strong, long-term employees, but also relies on college students to help support its seasonal employment needs. Brady says the company is utilizing a hybrid hiring approach, meaning that



Seated are company owners Skyler and Jen Akason. Standing are Brady, Chief Operations Officer (left), and Jon, Lawn Operations Manager.



employees could work on a lawn care crew one day and a landscaping crew the next. It all depends on where the manpower is needed at a particular point in time, because every aspect of Precision Lawn & Landscape's business has been booming.

Mowing Lawns Beats Becoming a Doctor

Skyler Akason started his company in 1997 while still in high school, mowing a handful of neighbors' lawns with a push mower. He kept things going while attending college as a pre-med student. His customer list continued to grow, though, and the workload got to be too much. After three years of college, Skyler decided he'd rather have a string trimmer in his hands than a stethoscope around his neck. He dropped out of college to focus on his business.

Skyler continued adding mowing accounts and soon branched into

snow removal. Landscape installation followed that. Mowing services were eventually supplemented with fertilizing and weed control. Skyler was also having to hire more and more employees, which was perhaps the biggest adjustment of them all.

"I'm a bit of a perfectionist, so I had a tough time trusting other people," Skyler relates. "I just felt like I needed to do everything myself, so I just kept pushing myself. But it got to a point where I

wasn't going to be able to keep growing like that."

Precision Lawn & Landscape now employs roughly 40 people during the growing season. Head count doubles during the snow season, though the majority are on-call positions.

"Snow removal is about half of our business in a typical year," says Skyler's wife, Jen, co-owner and Chief Financial Officer. The other half skews a bit

heavier toward landscaping. That said, mowing and lawn care have continued to provide a consistent, growing revenue stream over the past 10-plus years.

"We are mowing 28 commercial accounts, three of which are larger HOAs," says Jon, lawn operations manager. If you add up the individual units within those HOAs, together with the 208 residential properties and 25 other commercial properties the Precision crews mow, you're talking about a roster of nearly 500 lawns.

Precision's lawn care division has also seen strong growth with dethatching services, which they utilize their Walker Mowers to help deliver. "This spring we performed 184 dethatchings, along with all of the other normal spring cleanup services we provide," Jon points out. With respect to fertilizing and weed control, Precision has nearly 600 accounts. The company also added mosquito control to its service offering a couple of years ago.

Precision Lawn & Landscape has also added a new landscape installation service in recent years. "Fencing and decking were something completely new to us when we established them in 2020, after acquiring another company," Jen says. "We've continued to provide more services over the years as we've identified different customer needs."

"We offer everything a homeowner or property manager could want. That gives us an advantage because the customer can just deal with one company to get it all done."

"There are a lot of companies around here that are strictly landscaping or strictly lawn care," Skyler adds. "Plus, a lot of companies stay away from the snow removal side, simply because of the logistics involved. We offer everything a homeowner or property



Precision Lawn & Landscape's landscape installation team, from left: Kyle, senior lead landscape designer; Austin, landscaping project manager; Garrett, lead landscape designer; Lisa, lead landscape designer; Rory, decking and fencing operations manager.

manager could want. That gives us an advantage because the customer can just deal with one company to get it all done."

Work of Art, Model for Efficiency

Customers can also count on Precision Lawn & Landscape to get it all done right.

"We've implemented something we call 'instant customer engagement,'" Brady says. "Anytime a customer expresses a concern to a crew, either myself and/or Jon will arrange to meet with that customer immediately."

With as many properties as Precision's lawn care division is servicing, Brady says it's unrealistic to think crews will be perfect every single week. "As a

company, you have to be committed to mitigating a customer's concerns as quickly as possible," Brady says.

To further enhance the client experience, Precision lawn care crews meet for at least half an

hour every morning before being dispatched. Brady, Jon and other leaders pass along any mishaps from the prior day so crews can learn from those mistakes.

"We also pass along any compliments we've received," Brady adds. "That includes Google reviews and customers who call in. And if we receive any positive feedback throughout the day, we'll text the crew immediately while they are still in the field." When a company is as fussy as Precision Lawn & Landscape, positive reinforcement goes a long way in helping keep employees motivated.

Few are as motivated and impassioned as Jon. He became the lawn operations manager toward the end of 2023. He first joined Precision Lawn & Landscape in 2018 after the company he'd been working for was acquired by Precision. He started out operating Walker Mowers, just as he'd done throughout his previous 20-year career. While he has enjoyed the elevation to a management position, Jon can't hide the fact that he misses being in the field on a regular basis.

"I'm honestly jealous of my team members every day," Jon says. "We do try to get Jon out in the field once in a while," Skyler adds. Jon actually handles the company's lawn spraying an

in some of the company's more distant market areas. He also helps mow from time to time when the workload requires it. For the majority of the time, however, Jon is making sure the lawn care crews have what they need to maintain the high quality standard that has been set.

"The way I've always looked at things, the lawn is the canvas and the Walker Mower is our paintbrush," Jon says. "The artistry of mowing a lawn has always been the most rewarding thing for me, even now when I see the work our crews are doing when I'm out doing quality checks."

Precision Lawn & Landscape has a fleet of 13 Walkers. Aside from one older Model B with a side-discharge deck, the standardized machine

"The way I've always looked at things, the lawn is the canvas and the Walker Mower is our paint brush."

is a Model T, typically a T27i. The company generally fields two three-man commercial crews and three two-man residential crews. Each crew has two Model Ts, one with a 42-inch deck and the other with a 48. Clippings are always collected. Trailers feature hydraulic dump beds



Precision Lawn & Landscape has standardized grass collection with a Walker Model T across all of its maintenance crews.

to make it more efficient to unload the clippings at a local compost site at the end of the day.

Although he's only been in his management position for less than a year, Jon has made one astute

"We've found that the Walker Mower is the most efficient machine we can put in our operation," Jon says. "The maneuverability, flex deck and grass-handling capability really drive the efficiency of our mowing crews."

Jon says his Walker operators feel the same way he does, even the newbies who are just getting into lawn care. The easy operation of a Walker, coupled with the ability to create a beautiful picture, really seems to strike a chord. And once employees begin to refine their mowing skills, their pride grows even stronger.

"Our Walker operators look back and see that striping on a property," Jon says. "That image is rewarding to them, too, and inspires them to create new pieces of art."

observation. Having consistent equipment across crews helps ensure consistent service delivery. Well-trained team members and standardized equipment make it easy for crews to share resources as needed. It has to be the right equipment, though.



"Mark the lead mechanic" used to work in the field as both a mower operator and landscaping laborer. Now he's in charge of maintaining the company's massive fleet of 13 Walkers, countless pieces of handheld equipment, and a storage building full of trucks, tractors, skid loaders, snowplows and other equipment.

See Skyler's story by watching this video.



SCAN ME

Add-ons: Implements

Implement Hitch



The Implement Hitch allows the Walker Mower to use implements

Option: Tail Weights



Tail Weights offset the weight of an implement to maintain balance

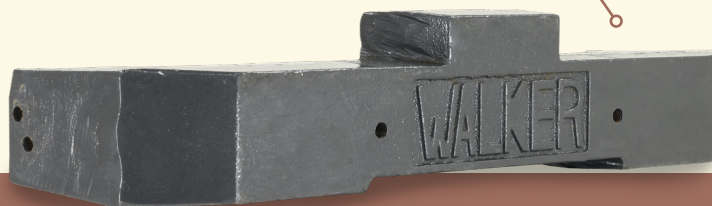

Walker implements mount interchangeably on most Walker models using the quick-change hitch system and require the use of the Implement Hitch. Tail weights may also be needed for counterbalancing.

Implement Hitch

The Implement Hitch can replace the mower deck and installs on the tractor in just a few minutes. Implements then slide onto the hitch and lock in place with the flip of a lever for true "quick-change"

capability. The Hitch assembly includes operator footrests and an electric power lift. A switch raises and lowers implements and is mounted on the Forward Speed Control lever for convenient operation.

Models C19, C19i, T, D:**P/N H10**
 Model H:.....**P/N H19**
 Models B, C23i:.....**P/N H22**

Option: Tail Weights

Tail weights are used for counterbalancing many Walker front-mounted add-ons such as a

snowblower, loader bucket, or rotary broom. Tail weights also improve handling when using large decks on the lighter models. The cast-iron weights bolt directly to the chassis frame or spread tail wheel axle.

Model B: 50 lb.....**P/N 4647-10**
 Extra 50 lb weight**P/N 4647-11**
 Model H: 50 lb**P/N 2647-10**
 Model H: 55 lb.....**P/N 2647-11**
 Extra 55 lb weight.....**P/N 2647-6**
 Model C19, C19i,
 T, D: 85 lb.....**P/N 7647**
 Extra 10 lb weight.....**P/N 7647-5**
 Model R: 80 lb.....**P/N 1647-10**

Rotary Broom

Great for removing snow or debris from textured surfaces



Five angle positions

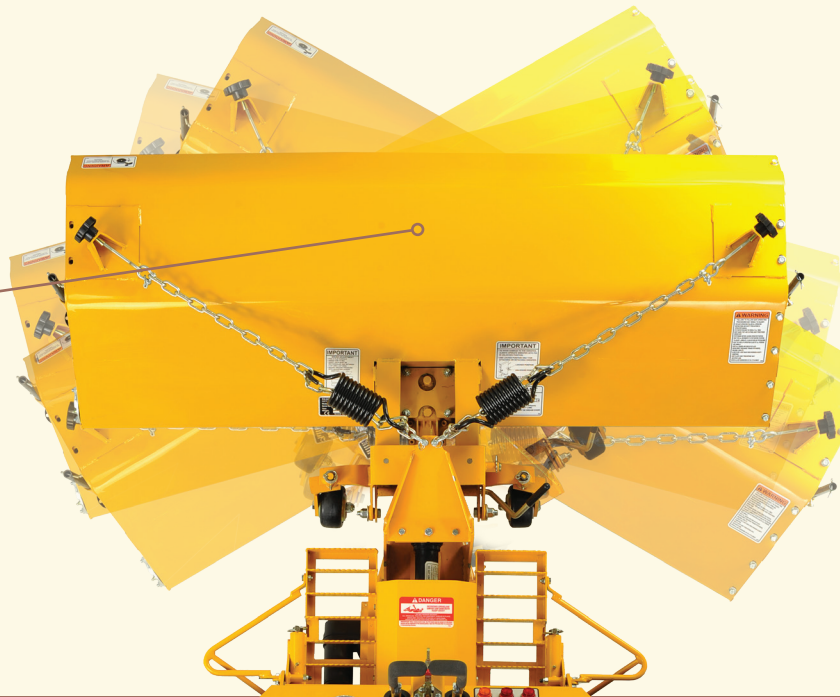

See all Walker implements:
walker.com/addons#implements

Rotary Broom

The Rotary Broom, with a 47" or 60" sweeping path and five-position angle head, is ideal for sweeping debris or light snow from hard surfaces.

The Rotary Broom excels at sweeping and removing gravel and debris from turf areas along roads, paths, and playing fields, and can also be used for lawn dethatching and raking. Down pressure is spring-counterweighted, and is adjustable for great sweeping

action and minimal brush wear. The Rotary Broom is another way to increase the utility and year-round productivity of the Walker Mower. Requires Implement Hitch (see page 48).

Models C, T, D: 47" **P/N H13**
 Model H: 60" **P/N H20**

Optional Gauge Wheels:
 Available to better control depth of brush engagement. Especially useful when working on turf. P/N I399



Add-ons: Implements

Dozer Blade (48" or 60")

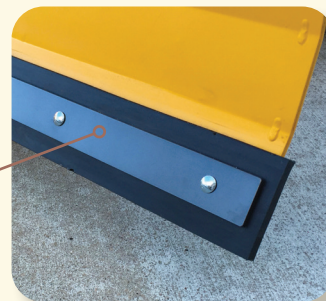

Replaceable steel wear edges

Loader Bucket

Push, scoop, or haul snow, dirt, stone, gravel, and mulch



Dozer Blade (48" or 60")

The Dozer Blade is a powerful tool able to tackle a variety of tasks, from cleaning up after a snowstorm to backfilling irrigation trenches. It is designed and built by Walker using the latest fabrication technology, precision tooling, and quality workmanship.

Blade design features a simple foot-actuated angle-adjust mechanism that allows the operator to quickly set the blade to five different positions. The

design also employs trip-over protection with adjustable preload, and +/-5° of lateral articulation to follow ground contour for even cleaning over the full width of the blade, and integrated footrests. The steel cutting edge is replaceable, with four mounting positions for extended life. Requires Implement Hitch (see page 48).

Models C, T, D, B, H:
48" (122 cm) **P/N H11**

Models T, D, H:
60" (152 cm) **P/N H16**

An optional Polyurethane Wear Edge Kit is available for use on sensitive surfaces:

48" (122 cm) **P/N 6625-10**
60" (152 cm) **P/N 6625-11**

Loader Bucket

A versatile tool for landscaping work, the Loader Bucket will push, scoop, haul, and grade dirt, stone, gravel, and mulch. It lifts approximately 180 lb (82kg), holds 2.25 cu. ft. (64 liter) of material, and features 14" (36 cm) ground clearance for transport. The Loader Bucket has high-strength steel

Debris Blower

Delivers 125 MPH velocity and a 230-degree manual directional control



Two-Stage Snowblower (42" or 50")

Throw snow up to 40 feet

Optional Chute Control Kit: P/N 6623-4

Note: Required for use with Operator Hard Cab.

construction with independent lift and dump controls powered by dual electric actuators. It is available for use on models T and D. The Loader Bucket requires an Implement Hitch (see page 48). **P/N H18**

Debris Blower

Useful for landscape cleanup and leaf removal, the Debris Blower quickly mounts to the Implement Hitch and gives the Walker Mower owner full, three-season use.

The 13.5" (35 cm) Debris Blower delivers 125 MPH velocity and a

230-degree manual directional control. The same high-quality construction found in each of our commercial mowers is built into this, and every implement we offer. It is available for use on models B, C, T, and D. It requires an Implement Hitch (see page 48).

P/N H14

Two-Stage Snowblower (42" or 50")

This powerful add-on throws snow up to 40 feet (12 meters) with a directional discharge spout that can be adjusted 228 degrees from

the operator seat. The chute pitch-adjustment allows for fine control of throw angle and distance, and comes with an optional electric control kit. With the electric height adjustment of the Implement Hitch, the Snowblower will make quick work of even the deepest of snowfalls. It requires an Implement Hitch (see page 48).

Models C, D, T, B, H:

42" (107 cm).....**P/N H12**

Model H: 50" (127 cm) **P/N H17**

Add-ons: Attachments

Walker hard and soft cabs provide protection from winter elements



Hard Cab



Soft Cab



Walker attachments mount interchangeably on most Walker models, and do not require the use of an Implement Hitch. Some attachments replace the deck, while others attach to the deck or to the tractor body.

Hard Cab

The Hard Cab shields the operator from winter weather when using a snowblower, rotary broom, or dozer blade. It includes two hinged doors, glass windshield with electric windshield wiper,

LED headlights, and circulation fan. It requires a ROPS kit for mounting (see page 49). Compatible only with H models. **P/N A33**

Optional Operator Cab Heater

Use only with Model H37i:
P/N 2200-24

Blade Angle Adjustment Kit

Use with 60" Dozer Blade:
P/N 6623-30

Snowblower Chute Control Kit

Use with 50" Snowblower:
P/N 6623-4

Soft Cab

The Soft Cab shields the operator from winter weather. It features a hinged door with glass windshield, electric windshield wiper, and LED headlights. **P/N A17**

Mounting Kits:

Models D, T..... **P/N 7660-23**
Model B **P/N 7660-24**
Model C19, C19i..... **P/N 7660-25**

Front Cab Extension Flap

Protects operator when using Dozer Blade: **P/N 7661-4**

ROPS

ROPS comes standard
on Model H24d

Single-Stage Snowblower 36"

Blow snow without an
implement hitch



Spyker® Spreader Attachment



See all Walker attachments:
walker.com/addons#attachments

ROPS

The Walker Roll-Over Protection Structure (ROPS) consists of a high-strength steel roll bar and retracting inertial-reel seat belt.* The ROPS system features a hinged roll bar that can be folded down for convenient transport and storage.

Models H27i, H24d.....**P/N A30**
Model H37i, H38i.....**P/N A34**
Models C19, C19i, D, T.....**P/N A37***

**Seat belt ordered separately,
Suspension Seat (6103-14) P/N 2302-8,
Standard Seat (5103) P/N 5103-9,
Comfort Seat (6104-31) P/N 6104-7.*

Single-Stage Snowblower 36"

Perfect for sidewalks and driveways, the 36" (91 cm) Single-Stage Snowblower attachment mounts directly in place of the mower deck. No separate implement hitch is required.

The Snowblower is a compact, powerful addition to the Walker Mower, throwing snow up to 20 feet. It is compatible with models S, C19, C19i, T, D, and B. **P/N A11**

Spyker® Spreader Attachment

The Spyker® Spreader Attachment combines a Spyker® S80-12010 Pro-Series Spreader with the versatile Walker Mower. No tools are needed to secure the spreader to the carrier frame of the Walker 42", 48", or 52" gear-driven decks.

Spyker® Spreader with Mount:
P/N A55

Add-ons: Attachments

Dethatcher



Tool-free
installation



Lift and remove
thatch quickly
and easily



Dethatcher

The Dethatcher on the front of the Walker Mower is the ideal setup to quickly dethatch and mow a property. When used with the Grass Handling System® on Models S, C, T, and D, lawn thatch and debris are lifted, vacuumed, and collected in one pass. The Dethatcher features front-gauge wheels which allow the dethatching tines to maintain consistent depth on uneven or articulating properties.

The Dethatcher quickly attaches

to the front of most 42", 48", and 52" Walker gear-driven decks with integrated, adjustable mounting saddles. A lift lever with foot trigger lowers and raises the Dethatcher for easy transport when driving between lawn areas. Gauge wheels are adjustable to set and tune tine depth. The foldable handle allows the Dethatcher to be stored vertically against a shop wall or tied down against a trailer sidewall.

P/N A10

Optional Wall Mount:

Securely and compactly mount the

Dethatcher off the floor in a space-saving manner on your shop or garage wall. **P/N 6606-11**

Optional Wall Mount



Boom Sprayer

Provides a 96" (244 cm) spray pattern to apply fertilizer or weed control



48" Dozer Blade

Options available for the A43 Dozer Blade:

Polyurethane Wear Edge Kit 48":
P/N 6625-10

Replaceable Steel Wear Edge

Boom Sprayer

A helpful attachment for property maintenance, the Boom Sprayer easily mounts to most 42", 48", and 52" Walker decks*, and offers a 96" (244 cm) spray pattern, allowing operators to apply fertilizer or weed control in an efficient manner. A spray gun with a 20-foot (6 meter) hose allows the operator to leave the mower and apply liquid material to all landscape features. The spray tip adjusts to offer varying output, from a mist to a 35-foot (11 meter) stream.

The 25-gallon (95 liter) tank allows easy cleaning of the tank and spray system. **P/N A57**

48" Dozer Blade

The 48" Dozer Blade incorporates a manual lifting mechanism with foot trigger release and built-in footrests not requiring an implement hitch. It features a foot-actuated, angle-adjust mechanism that allows the operator to quickly set the blade to five different angles. The blade employs trip-over protection. A replaceable steel wear edge

comes standard, and an optional polyurethane wear edge is also available. The blade mount also allows +/-5 degrees of lateral articulation to follow ground contour for even clearing over the full width of the blade. Tail weight required with use of blade. See page 48.

Models S, C, T, D, B **P/N A43**
Model R **P/N A44**

*Mounting on 52" decks requires two Rear Sprayer Supports P/N B037.

Add-ons: Options

Comfort Seat embroidery

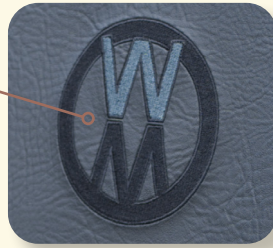

Armrests



Comfort Seat

Suspension Seat

Suspension Seat absorbs bumps as the mower goes over rough terrain



Comfort Seat

The Comfort Seat, standard on Models T, B, and C23i, is custom-designed with improved seat-bolstering and back profile for increased posture support. The base cushion features Elastomeric Vibration Control which greatly increases comfort during operation. Matching armrests are available as an optional upgrade.

Model Compatibility:

T, D *P/N 6104-8*
 B, S, C19, C19i *P/N 6104-9*

R *P/N 6104-10*
 Optional Armrests *P/N 6104-17*

Suspension Seat

Made by Grammer, this full-spring Suspension Seat includes dampening and adjustments for back angle, lumbar support, and operator weight. Armrests are standard on the Suspension Seat. This seat is standard on Models D21d and H24d, and is required for a ROPS seat belt. *P/N 6103-14*

Required Mounting Kits by Model:
 B23, B27i *P/N 6103-51*

C19, C19i *P/N 6103-52*
 C23i *P/N 6103-55*
 H *P/N 6103-53*
 T *P/N 6103-54*

Armrests

Foldable Armrests can be added to the Comfort or Standard Seat. They offer enhanced operator comfort and security. Armrests conveniently fold up when not in use. Armrests are standard equipment on the Suspension Seat.

Standard Seat: *P/N 5885*
 Comfort Seat: *P/N 6104-17*

Utility Bed



Headlights



Increased safety for early morning and evening work

Cup Holder



Instrument Panel Cover



See all Walker options:
walker.com/addons#options

Utility Bed

The Utility Bed is an option for the Model B, providing convenient storage and transport of material or tools with a manual dump functionality. It is standard on Models H24d and the non-collection versions of T23, T27i, and D21d. **P/N 4650-2**

Headlights

The LED Headlights are positioned to illuminate the front and sides of the mower deck, providing increased situational awareness

and safety for both the operator and bystanders.

- Models C19, C19i, H27i, and H24d.....**P/N 5989-13**
- Model B**P/N 5989-17**
- Model S..... **P/N 5989-14**
- Model R**P/N 5989-15**
- Models D, T.....**P/N 7989-14**
- Model H38i **P/N 2989-12**
- Model C23i **P/N 5889-19**

Cup Holder

Featuring a unique front-mount design, the Cup Holder gives the

operator easy access to a drink. The Cup Holder frame is powder-coated metal and incorporates rubber tabs to secure different sized and shaped cups and tumblers up to 3.25" in diameter. It is compatible with all models except Model R. **P/N 5744-9**

Instrument Panel Cover

This sturdy canvas Instrument Panel Cover protects the instrument panel on Walker Models D and T when parked outside or trailered in rain or snow. **P/N 7307-2**

Add-ons: Options

Power Dump



Dump grass without leaving your seat



Power Dump

The Power Dump provides convenience and time savings to commercial mowing companies and homeowners alike by giving the operator the ability to dump the grass catcher from the operator seat. A toggle switch operates the 12-volt electric linear actuator that provides the dumping and door-opening action, which completes in about 10 seconds.

Model S18 (for 7.0 bu.):
P/N A48

Model C19, C19i (for 7.0 bu.):
P/N A46
Model C23i (for 10.0 bu.):
P/N A52
Models T, D (for 10.0 bu.):
P/N A51

Hi-Dump®

The Walker Hi-Dump® raises 67" (170 cm) and dumps collected grass and debris into a truck or trailer in a 20-second cycle, without the operator ever needing to leave the seat. Powered by a 12-volt electric/hydraulic system, the

Hi-Dump®

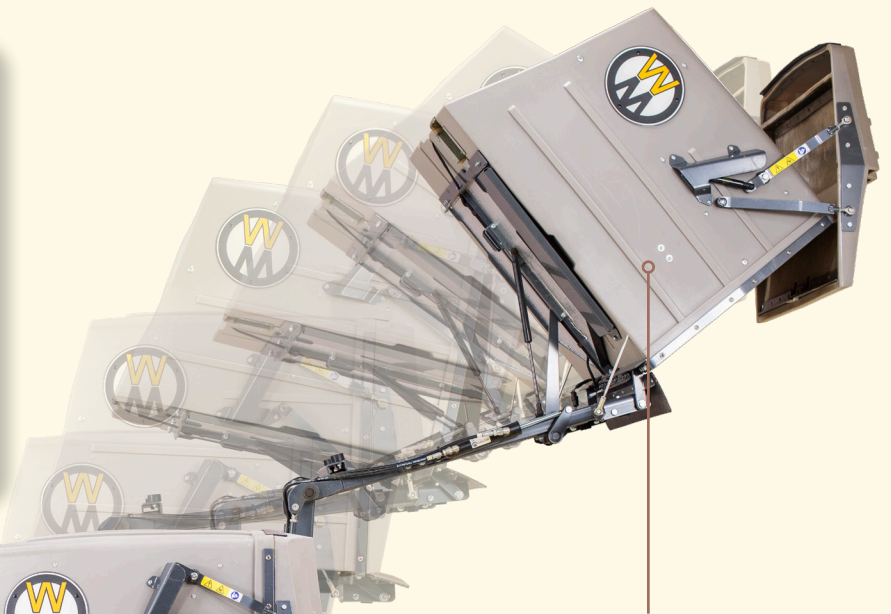

Lifts up 67" (170 cm) for easy dumping into a truck or trailer

lifting and dumping functions work independently and are controlled by two toggle switches near the operator seat. It is available for Models D and T. **P/N A21**



GHS Blower Lockout

Transfer power when not using the Grass Handling System®

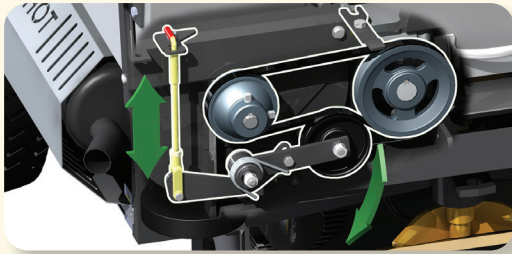

Dump Bag



No-Catch Deflector

Convert collection into rear discharge



No-Catch Deflector

The No-Catch Deflector installs in the grass catcher door frame to allow rear-discharge mowing on GHS models. Grass clippings are safely deflected downward.

For 7.0 bu. Catcher.....*P/N 7500-2*

For 10.0 bu. Catcher.... *P/N 8500-2*

GHS Blower Lockout

The Blower Lockout disengages the Grass Handling System® (GHS) blower to reduce noise and increase power when using a side

discharge deck, mulching deck, or PTO-driven attachment or implement. Disengaging the blower also prevents grass, snow, or debris from entering the grass catcher.

P/N 7541-1

Dump Bag

The reusable, fabric Dump Bag helps make on-the-job cleanup a lot easier. It is sized to fit the 10.0 bu. catcher door opening, allowing the operator to cleanly handle clippings and easily transport them.

P/N 5598-2

The reusable, fabric Dump Bag helps make on-the-job cleanup a lot easier.



Add-ons: Options

Curb Jumper

A ramp right where you need it



Store as a footrest



Dump Bins



Large Hole Screen

Prevent clogging in wet conditions



Dump Bins

These two bins slide into the Walker 10-bushel catcher, making the dumping of grass clippings much easier by dividing the weight.

Set of Dump Bins..... **P/N 8510-11**

Left Dump Bin **P/N 8510-9**

Right Dump Bin **P/N 8510-10**

Large Hole Screen

The 3/4" holes in this screen help prevent clogging in wet conditions.

7.0 bu. Catcher..... **P/N 7512-13**

10.0 bu. Catcher **P/N 7512-11**

Curb Jumper

This 36" (91 cm) wide curb ramp allows Walker Mowers to easily back over a standard curb for access to medians, and landscape areas in parking lots. When not in use, the ramp stows on the mowing deck carrier frame and functions as an expanded footrest.

Standard decks except 48" and 52", prior to deck S/N 220949*
P/N 5597

Decks with Deck Height Adjuster (A22-A29 only) **P/N 5597-1**

When not in use, the ramp stows on the mowing deck carrier frame and functions as an expanded footrest



Power Tilt-Up®

Avoid heavy manual lifting by mechanically lifting the deck instead



Control panel on the rear of the mower for safe operation

Breakaway Blades

Reduce damage when mowing debris



Dense-Pak Blades

Reduce the size of clippings



Power Tilt-Up®

Available for the Model H, the Power Tilt-Up® makes it easy to automatically tilt up decks for maintenance, transportation and storage. Tilt-up action uses a 12-volt electric linear-actuator easily mounted to any Model H mower equipped with an S61, R52, or R64 deck with adjustable footrests. The use of a tail weight is suggested when using this option (see page 48).

Models H27i, H38i **P/N A35**
Model H24d **P/N A36**

Breakaway Blades

For use in mowing conditions with frequent ground contact and/or excessive debris. Breakaway Blades lessen the impact and shock loading on the deck drivetrain and reduce blade damage. Cutting blades can be easily replaced or removed for sharpening.

S56 **P/N 5705-32**
S42 **P/N 5705-33**
S74 **P/N 5705-34**
S48 **P/N 7705-8**

Dense-Pak Blades

Use Dense-Pak Blades to reduce size of clippings for a more densely loaded catcher when using the Grass Handling System® (GHS); allowing for longer mowing times before needing to dump the catcher.

This blade set offers both right hand and left hand serrated wing blades for the counter-rotating function of the collection deck.

P/N 7705-60

Add-ons: Options

Hand Lever Deck Height Adjuster



Foot Pedal Deck Height Adjuster



Fine-tune cutting height

Deck Height Adjusters

Both the Hand Lever Deck Height Adjuster and Foot Pedal Deck Height Adjuster install directly onto the Walker mowing deck. They offer quick and easy cutting height adjustments in 1/4" increments, using a single hand lever or foot pedal within reach from the operator's seat.

Hand Lever Deck Height Adjuster

C36R, S36, M36 **P/N A22**

C42, S42, M42* **P/N A23**
 C48, S48, M42B, M48* **P/N A24**
 C48R, C52R* **P/N A25**
 S56 **P/N A28**
 C42R **P/N A29**

Foot Pedal Deck Height Adjuster

C42, S42, M42* **P/N A53**
 C48, S48, M42B, M48* **P/N A54**
 C48R, C52R* **P/N A54**
 M52* **P/N A54**

Deck Height Washers

Deck Height Washers allow finer adjustments of cutting height on compatible decks. Use these to adjust deck height by 1/4".

36", 42", 48", 52", 54", 56" gear or belt drive decks: **P/N 5727-1**
 74" gear drive deck: **P/N 8727**

Deck Height Washers



*See dealer for compatibility details.

Key Walker deck design features like Flexible Deck Suspension and True Floating Deck are maintained in the Deck Height Adjuster by using slotted lift links and controlling the overall weight of the design.

Slotted lift links and easy install deck connections

Actuating Lever with Lockout Tab

Greaseable moving parts

Easy-to-install design bolts to carrier frame

Built-in guards protect moving parts



Height Increments in 1/4" settings

Foot Pedal Deck Lift

Hitch Pin

Adjust deck height from seat using a single foot pedal with the Foot Pedal Deck Height Adjuster A53 or A54

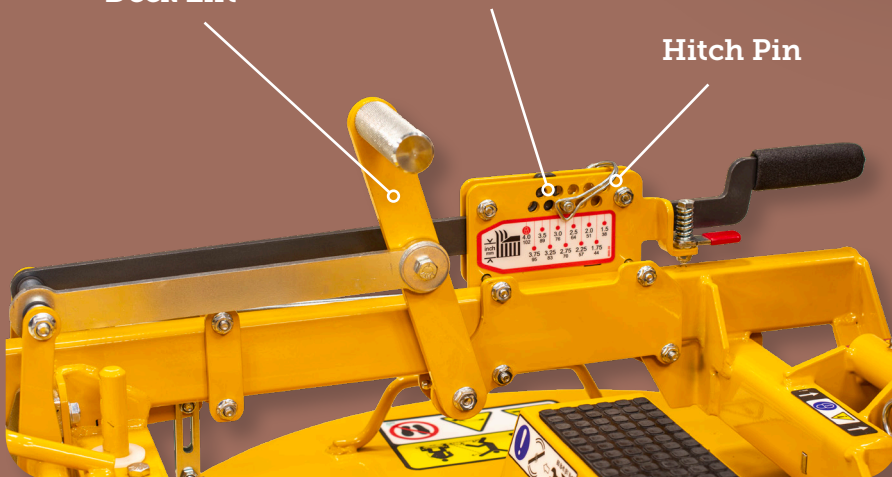

Add-ons: Options



Deck Cuff

Direct grass into the cutting path

Spread Axle Tail Wheel

Having a wider wheel base means having better hillside stability



Dual Tail Wheel

Less turning resistance with greater agility

Deck Cuff

Airflow and deck contour tend to push grass at the very edges of the deck away from the cutting blades. The Deck Cuff acts as a channel to direct grass at the edge of the deck into the blade cutting path, restoring full deck cutting width.

- C36R *P/N 7704-2*
- C48R *P/N 7704-4*
- C52R..... *P/N 7704-5*

Spread Axle Tail Wheel

The Spread Axle Tail Wheels track in line with the drive tires for grass conditions where the center tail wheel track may not be preferred. This offers a clean look to the striping, improves straight tracking, and also contributes to stability when operating on hillsides.

- Spread Axle Assembly:
- D, T, C19, C19i *P/N 7420-3*
 - C23i *P/N 7420-13*

Tank Relocation Kit Required for D21d: *P/N 7420-8*

Dual Tail Wheel

The Dual Tail Wheel comes standard on Models T, D, and C23i (equipped with 10.0 bu. catcher). Featuring two independent pneumatic tires, it offers less turning resistance than the Single Wide Tail Wheel, offering mowing with greater agility and precision.

P/N 7420-20

Single Wide Tail Wheel

Creates a single,
uniform tire stripe



Adjustable Footrests

Better comfort for
operators with shorter legs



Single Wide Tail Wheel

The Single Wide Tail Wheel creates a single, uniform tire stripe in the middle of the cutting width for a clean-looking stripe pattern. It is not recommended for delicate turf, D Models, or machines equipped with a Hi-Dump® due to the increased turning friction/resistance at the contact point of the tail wheel. **P/N 8049**

Adjustable Footrests

These Adjustable Footrests clamp onto the carrier frame. They are easy to install and adjust, making for a comfortable ride for operators with shorter legs.

36", 42" **P/N 8662-10**
74" **P/N 8662-9**

Single Wide Tail Wheel P/N 8049



Add-ons: Options

Tail Wheel Lock

Lock tail wheel in "straight ahead" position to help create straight stripes

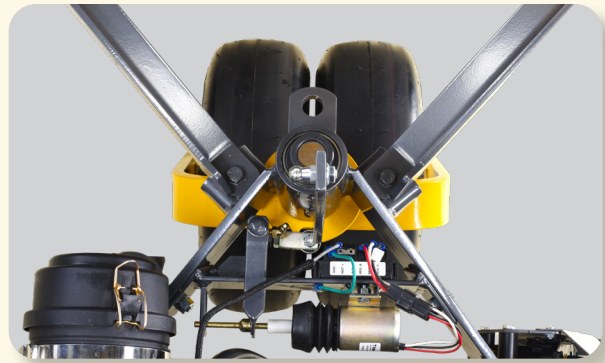

Big Tire Fork Kit

For faster, more comfortable operation



Taller Deck Caster Forks

Larger, 20" Drive Tires

Taller Tail Wheel Fork

Tail Wheel Lock

The Tail Wheel Lock uses a locking solenoid and detent to hold the tail wheel into a "straight ahead" position. This dramatically improves the ability to create straight stripes and increases stability for hillside mowing. An On/Off toggle switch located on the Forward Speed Control makes it easy to control from the operator seat. **P/N 8540**

Big Tire Fork Kit

This kit, available for Model B, uses a larger, 20" drive tire (purchased separately¹) along with taller tail wheel and deck caster forks. It provides increased cutting heights up to 5", higher ground speed, and improved operator comfort in rough conditions.

For Model B use:

With 8" Deck Tires

- Forks for tractor and deck

P/N 5076-12

- Forks for deck only

P/N 5770-99

With 11" Deck Tires

- Forks for tractor and deck

P/N 5076-13

- Forks for deck only

P/N 8765-17

- With S60 or S52², forks for deck only

P/N 5076-14

¹: 20" drive tires, required for the Big Tire Fork Kit, are purchased separately from the kit. For 20" drive Turf Tires, order two P/N 5076-3. For 20" drive AT Tires, order two P/N 8070-20. ²: See dealer for compatibility details.

Turf Tires

18 x 7-8 Turf Tire

For use on narrow decks



18 x 8.5-10 Turf Tire

Standard on Models B, C, and S18, and T and D with ROPS



18 x 9.5-8 Turf Tire

Standard on Models T and D without ROPS



18 x 10.5-10 Turf Tire

Preferred for delicate turf and hills



Turf Tires

18 x 7-8 Turf Tire

The 18 x 7-8 Turf Tire is ideal for use with narrow decks, attachments, or implements. With these tires, the overall width of the tractor stays within the cut width of Walker's 36" decks. Compatible with Models S, C19, C19i, T, D, R, and B. **P/N 5033-6**

18 x 8.5-10 Turf Tire

The 18 x 8.5-10 Turf Tire features a low-profile sidewall for increased stability on slopes and less sidewall

flex in turns. The 18 x 8.5-10 Turf Tire keeps overall tractor width less than 42", ideal for narrower decks, attachments, or implements. This tire is standard on Models B, C, S18, and Models T and D with ROPS. Compatible with Models S, C, T, D, R, and B. **P/N 5075-3**

18 x 9.5-8 Turf Tire

The 18 x 9.5-8 Turf Tire is a good balance of low ground pressure, operator comfort, and deck overhang for trimming ability. It is the standard tire on Model T and Model D Walker Mowers without

ROPS. Compatible with Models S, C, T, D, R, and B. **P/N 7070-2**

18 x 10.5-10 Turf Tire

The 18 x 10.5-10 Turf Tire provides optimum traction and a large contact area, reducing ground pressure and protecting the turf. The low-profile sidewall improves hillside handling. Due to its width, and for optimal trimming, it should be paired with 48" or larger decks. Compatible with Models C, T, D, B, and R. **P/N 8075-4**

Add-ons: Options

All Terrain Tires

18 x 7-8 Directional AT Tire

Pair with 36" snowblower, 48" dozer blade, or 36-42" decks

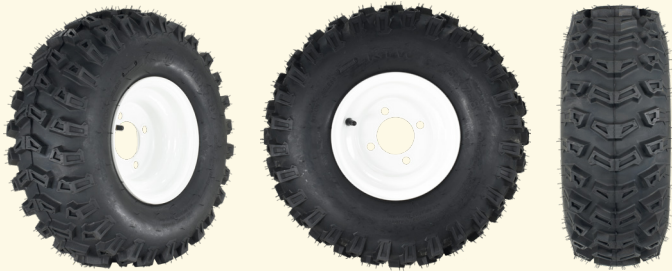

18 x 8.5-10 AT Tire

Improved trimming capability, and dozer blade side reach

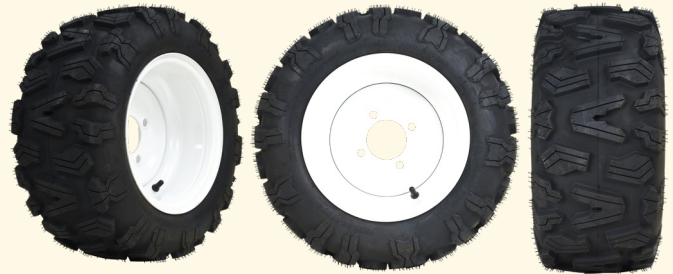

18 x 11-10 AT Tire

Increased traction and performance on hillsides



23 x 10.5-12 AT Tire

Standard on Model H, increased traction and performance on hillsides



All Terrain Tires

18 x 7-8 Directional AT Tire

The 18 x 7-8 AT Tire features a high-traction, directional tread. It is ideal for increased traction in situations such as snow removal, dirt work, and mowing where a narrow tire is needed. It is perfectly paired with the 36" Single-Stage Snowblower, the 48" Dozer Blade, or 36" and 42" decks. Compatible with Models S, C19, C19i, T, D, R, and B.

Left Drive Tire: **P/N 5034-1**
Right Drive Tire: **P/N 5034-2**

18 x 8.5-10 AT Tire

This aggressive 18 x 8.5-10 high-traction tire features increased traction useful for snow removal, dirt work, and other challenging mowing conditions. The tire width improves trimming capability as well as dozer blade side reach. Compatible with Models S, C, T, D, R, and B. **P/N 8070-9**

18 x 11-10 AT Tire

The 18 x 11-10 All Terrain Tire is ideal for increased traction in a variety of situations ranging from hillside mowing to snow removal.

It also features a low-profile sidewall for increased stability and performance. Compatible with Models C, T, D, R, and B.

P/N 8070-12

23 x 10.5-12 AT Tire

The 23 x 10.5-12 All-Trail Tire features a moderately aggressive, bi-directional tread pattern ideal for challenging turf applications. The All-Trail Tire improves traction and hillside performance for the Model H. Compatible with Model H.

P/N 2071-4

All Terrain Tires

23 x 10.5-12 Directional AT Tire

Ideal for snow, dirt, and challenging mowing conditions



Tire Chains

Extra traction for snowy conditions



Deck Tires

Semi-Pneumatic Deck Tire

Standard tires for most Walker decks

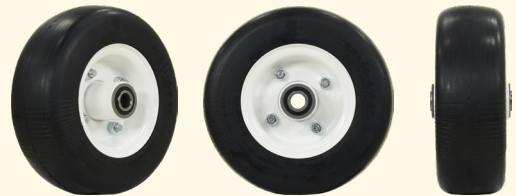

Pneumatic Deck Tire

Adjust air pressure to fine-tune performance



23 x 10.5-12 Directional AT Tire

This Directional All-Terrain Tire provides improved traction and is ideal for snow removal, dirt work, and challenging mowing conditions. The tread layout is open enough to shed snow while also performing well on manicured turf. Compatible with Model H.

Left Tire: **P/N 2070-5**

Right Tire: **P/N 2070-6**

Deck Tires

Semi-Pneumatic Deck Tire

The Semi-Pneumatic Deck Tires

are molded, structural rubber with a hollow core, and come standard on most Walker Decks. Compatible with Models S, C, T, D, and B.

Tire, wheel and axle assembly: **P/N 5715-23**

Tire only: **P/N 5715-16**

Pneumatic Deck Tire

The Pneumatic Deck Tires can replace the standard, semi-pneumatic tires to allow for adjustment of air pressure to fine-tune the performance of the deck. Compatible with Models S, C, T, D, and B.

Tire and inner tube only:

P/N 5715-15

Tire, inner tube, and wheel assembly: **P/N 5715-24**

Tire Chains

The Tire Chains are used for extra traction while working in snow with a Walker Snowblower, Rotary Broom, or Dozer Blade. There are tire chains to fit every Walker model.

18 x 6.5-8 **P/N 5675**

18 x 8.5-8 **P/N 5675-2**

18 x 9.5-8 **P/N 5675-3**

22x10.5-12 **P/N 5675-6**

Add-ons: Compatibility

42" Snowblower



Boom Sprayer



Power Dump



	Models						
	S	C	T	D	R	B	H
Implements							
Implement Hitch ¹		●	●	●		●	●
47" Rotary Broom		●	●	●		●	
60" Rotary Broom							●
48" Dozer Blade		●	●	●		●	●
60" Dozer Blade			●	●			●
Loader Bucket			●	●			
Debris Blower		●	●	●		●	
42" Two-Stage Snowblower		●	●	●		●	
50" Two-Stage Snowblower							●
Attachments							
Operator Soft Cab		▲	●	●		●	
Operator Hard Cab							●
ROPS		▲	●	●			●
36" Single-Stage Snowblower	●	▲	●	●		●	
Dethatcher ²	●	●	●	●		●	
Boom Sprayer ²	●	●	●	●		●	●
48" Dozer Blade	●	●	●	●	●	●	
Spyker [®] Spreader with Mount	●	●	●	●		●	
Options							
Comfort Seat	●	●	●	●	●	●	
Suspension Seat		●	●	●		●	●
Armrests	●	●	●	●	●	●	●
Utility Bed			●	●		●	
Headlights	●	●	●	●	●	●	●
Cup Holder	●	●	●	●		●	●
Instrument Panel Cover			●	●			
Tail Weights		●	●	●		●	●
Power Dump	●	●	●	●			

● Compatible. ▲ Compatible with Model C19 only, not C23i. ¹ Required for use of compatible implements. ² Visit walker.com for a full list of compatible decks.

Add-ons: Compatibility

Hi-Dump®



Power Tilt-Up®



Models

S	C	T	D	R	B	H
---	---	---	---	---	---	---

Options (continued)						
Hi-Dump®			•	•		
Large Hole Screen	•	•	•	•		
No-Catch Deflector	•	•	•	•		
GHS Blower Lockout		▲	•	•		
Dump Bag	•	•	•	•		
Dump Bins		X	•	•		
Deck Height Adjuster ²	•	•	•	•		•
Deck Height Washers ²	•	•	•	•		•
Curb Jumper ²	•	•	•	•		•
Power Tilt-Up®						•
Breakaway Blades ²	•	•	•	•		•
Adjustable Footrests ²	•	•	•	•		•
Deck Cuff ²	•	•	•	•		
Spread Axle Tail Wheel		•	•	•		
Dual Tail Wheel		X	•	•		
Single Wide Tail Wheel		X	•	•		
Tail Wheel Lock			•	•		
18 x 7-8 Turf Tire	•	▲	•	•	•	•
18 x 8.5-10 Turf Tire	•	•	•	•	•	•
18 x 9.5-8 Turf Tire	•	•	•	•	•	•
18 x 10.5-10 Turf Tire		•	•	•	•	•
18 x 7-8 Directional AT Tire	•	▲	•	•	•	•
18 x 8.5-10 AT Tire	•	•	•	•	•	•
18 x 11-10 AT Tire		•	•	•	•	•
23 x 10.5-12 AT Tire						•
23 x 10.5-12 Directional AT Tire						•
Semi-Pneumatic Deck Tire ²	•	•	•	•		•
Pneumatic Deck Tire ²	•	•	•	•		•
Tire Chains ³	•	•	•	•	•	•

• Compatible. ² Visit walker.com for a full list of compatible decks. ³ Visit walker.com for a full list of compatible tires. ▲ Compatible with Model C19 only, not C23i. X Compatible with Model C23i only.

Walker Mower Specifications

	S18	C19	C23i	T23	T27i	D21d	R22	B23	B27i	H24d	H27i	H38i
Engine	BBS Vanguard	Kohler CH620	Kohler ECH730	Kohler CH680	Kohler ECH749	Kubota D722 Diesel	Kohler KT722 Carb	Kohler CH680 Carb	Kohler ECH749 EFI	Kohler KDW1003 Diesel	Kohler ECH749 EFI	Kohler ECH980 EFI
Fuel System	Carb	Carb	EFI	Carb	EFI	Diesel	Carb	Carb	Air	Air	Air	EFI
Cooling System	Air	Air	Air	Air	Air	Liquid	Air	Air	Air	Liquid	Air	Air
Displacement, cc	570	674	747	674	747	719	747	674	747	1028	747	999
HP @ 3600 RPM	18	19	23	22.5	26.5	20.9	22	22.5	26.5	23.7	26.5	38
Max Torque, ft-lbs	29.2	35	38.1	36.8	40	34	40.4	36.8	40	36.8	40	53
Fuel Capacity, US gal (liter)	4 (15.1)	4 (15.1)	4.7 (17.8)	4.7 (17.8)	4.7 (17.8)	4.7 (17.8)	3 (11.4)	4.7 gal (17.8)	4.7 (17.8)	9.4 (35.6)	9.4 (35.6)	9.4 (35.6)
Drive Tire Size, diameter x width	18x8.5	18x8.5	18x8.5	18x9.5	18x9.5	18x9.5	18x8.5	18x8.5	18x8.5	23x10.5	23x10.5	23x10.5
Top Speed, MPH (km/h)	7.4 (12)	6.5 (10.5)	8 (13)	6.5 (10.5)	6.5 (10.5)	6.5 (10.5)	7 (11.3)	8 (13)	8 (13)	10 (16)	10 (16)	10 (16)
Tractor + Deck ¹ Length inch (cm)	89.25 (226.69)	89.25 (226.69)	96.25 (244.47)	93 (236.22)	93 (236.22)	93 (236.22)	91.1 (231)	90.75 (230)	90.75 (230.50)	107.75 (274)	107.75 (274)	107.75 (274)
Tractor + Deck ¹ Tilted Length inch (cm)	77 (195.58)	77 (195.58)	77 (195.58)	77 (195.58)	77 (195.58)	77 (195.58)	77 (195.58)	72 (183)	72 (182.88)	87.75 (222.88)	87.75 (222.88)	87.75 (222.88)
Height, inch (cm)	46.5 (118.11)	47.5 (120.65)	50 (127)	50 (127)	50 (127)	50 (127)	42 (106.68)	39.5 (100.33)	39.5 (100.33)	50.5 ³ (128.27)	47.25 (120)	47.25 (120)
Tractor Only Width, inch (cm)	38.5 (98)	37.75 (95.88)	41 (104.14)	39 (99.06)	39 (99.06)	39 (99.06)	39 (99.06)	38.5 (97.79)	38.5 (97.79)	46.5 (118.11)	46.5 (118.11)	46.5 (118.11)
Tractor Only Weight, lb (kg)	675 (306)	762 (346)	780 (354)	820 (372)	815 (370)	1000 (454)	404 (183)	600 (272)	606 (275)	997 (452)	748 (340)	808 (367)
Tractor + Deck ² Weight, lb (kg)	866 (393)	953 (432)	991 (440)	1039 (471)	1034 (469)	1219 (553)	575 (260)	812 (368)	812 (368)	1434 (650)	1185 (537)	1245 (565)

¹S, C19; C42, C23i, T and D; C48, R; S48, B; M48, H; R64, ²S; C36, C19; C42, C23i, T and D; C48, R; 42³; B; S48, H; R64, ³ROPS folded. Note: The A21 Hi-Dump Kit weighs 175 lbs (79 kg).

Standard Features

- Gasoline engines require unleaded 87+ octane
- Diesel engines require 2-D
- Full pressure lube systems with filter
- Heavy-duty stamped steel cutting blades, tempered
- Flywheel alternator charging, D21d has belt-driven alternator
- Internal mechanical parking brake
- Safety circuitry provided by safety switches: seat, transmission neutral, blade clutch, and parking brake
- Electric blade clutch with easy pull/push switch operation on Models R, B, S and C23i
- Dual-lever steering, precision friction-lock Forward Speed Control lever with neutral/park position
- All machines feature dual, independent hydrostatic transmissions
- Cutting height 1.5" to 4", 1.5" to 4.5", or 1" to 5", varies per model
- Welded, heavy gauge, steel chassis
- Decks and add-ons powered by splined PTO shaft with dual u-joints allowing dynamic articulation, except for the Model R
- Deck carrier frame with flexible deck suspension, caster wheels, and counterweight springs
- Welded, 14 gauge steel bodies
- Welded, 11 gauge steel decks
- 12V electrical systems
- Blade clutch and brake with manual belt tightener C19, T, D, H

